

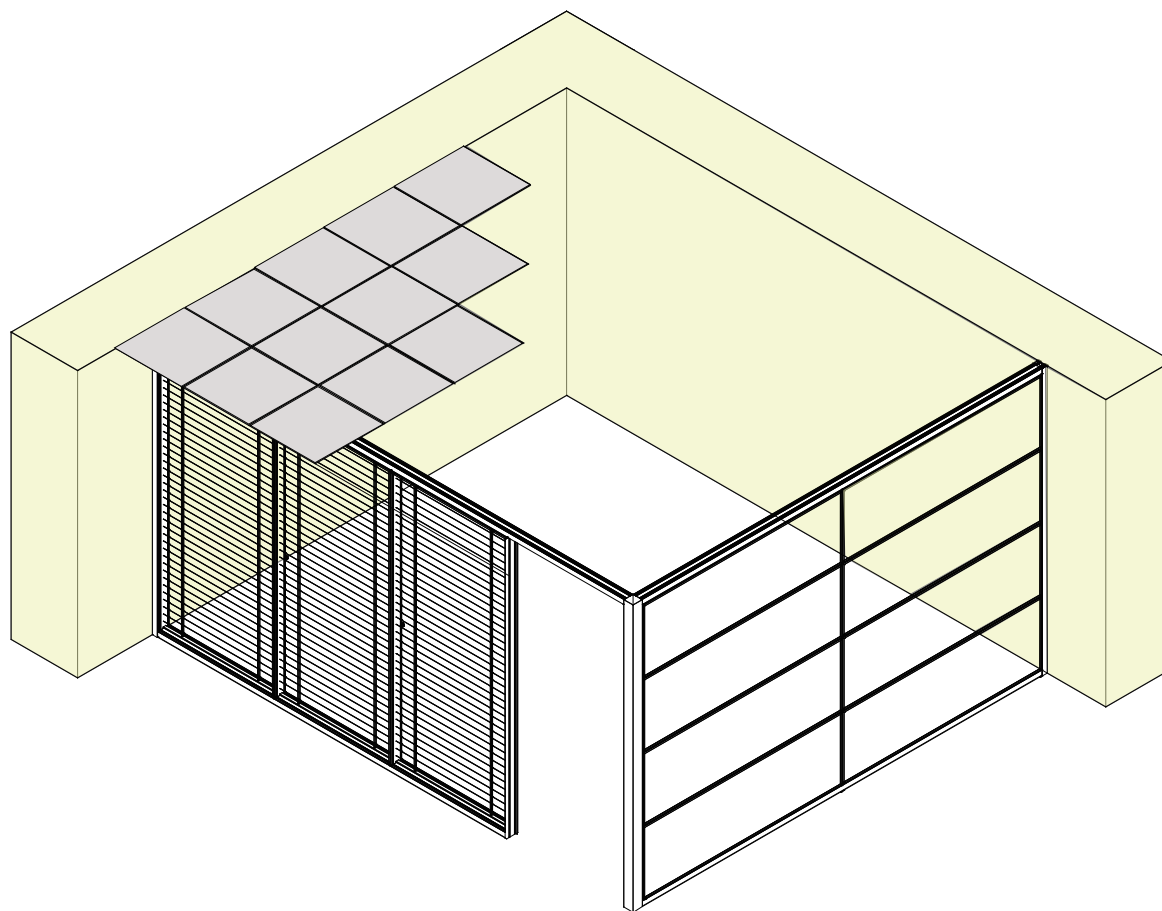

## 800 Series Installation Instructions



Scan the QR code to watch the YouTube tutorial!

Vension No:20130815

# Contents

<b>1 Toolings .....</b>	<b>1</b>
<b>2 Components .....</b>	<b>1</b>
<b>3 Components installation .....</b>	<b>1</b>
Typical 1: Partition up to ceiling .....	1
3.1 Wall starter installation & vertical adjustment .....	2
3.2 Top and bottom groove installation & vertical adjustment .....	2-3
3.3 Corner pole installation .....	4
3.4 Horizontal panels connection .....	4-5
3.5 Vertical panels connection .....	6-7
3.6 Blind installation .....	7-8
Typical 2: Partitions not up to ceiling .....	9
<b>4 Door Illustration .....</b>	<b>9</b>
4.1 Wood swing door illustration .....	10-17
4.2 Glass swing door illustration .....	18-20
4.3 Glass sliding door illustration .....	21-23

## 1 Toolings

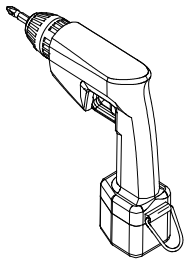

Electric drill

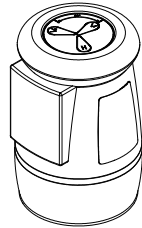

Gradienter

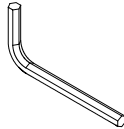

Allen key

## 2 Components

Wall starter

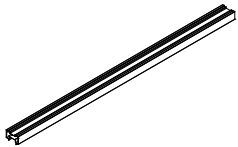

Ceiling connection

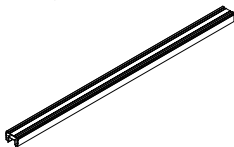

Bottom connection

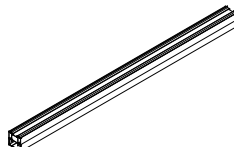

Vertical panel



Horizontal panel

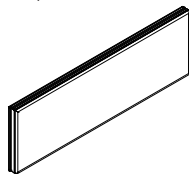

Corner pole



Blind

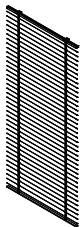

Top bar

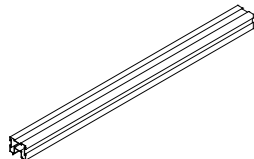

## 3 Component installation

Typical room :

Typical 1: Partition up to ceiling

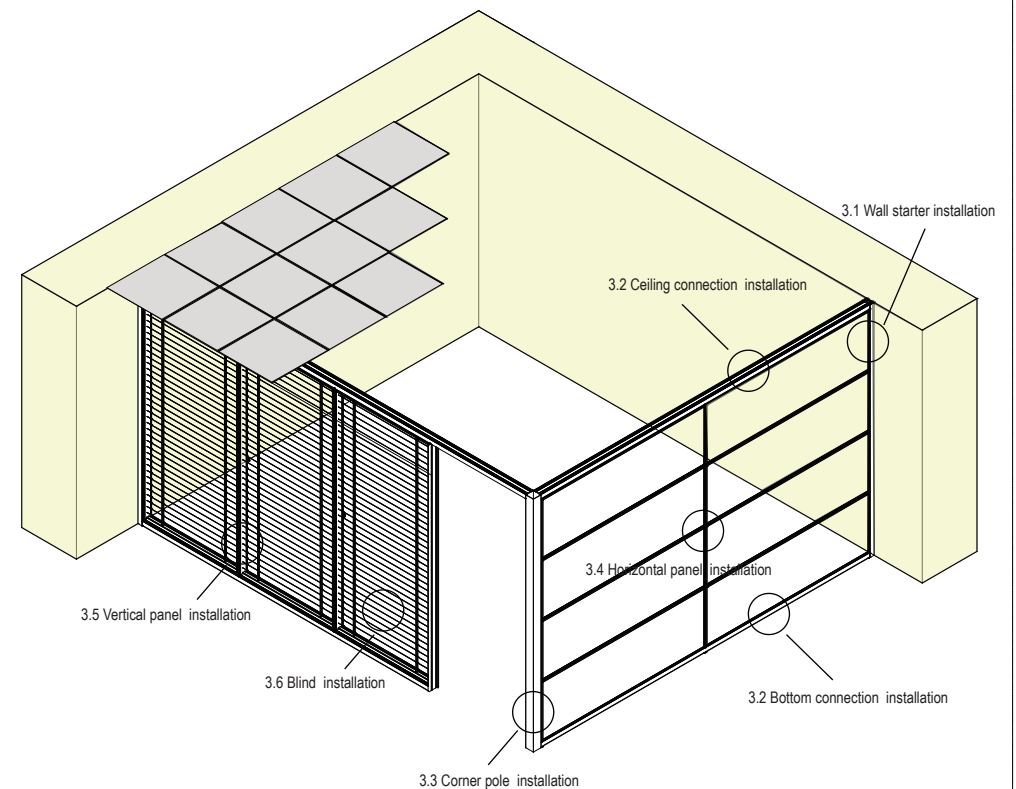

### 3.1 Wall starter installation & vertical adjustment

1

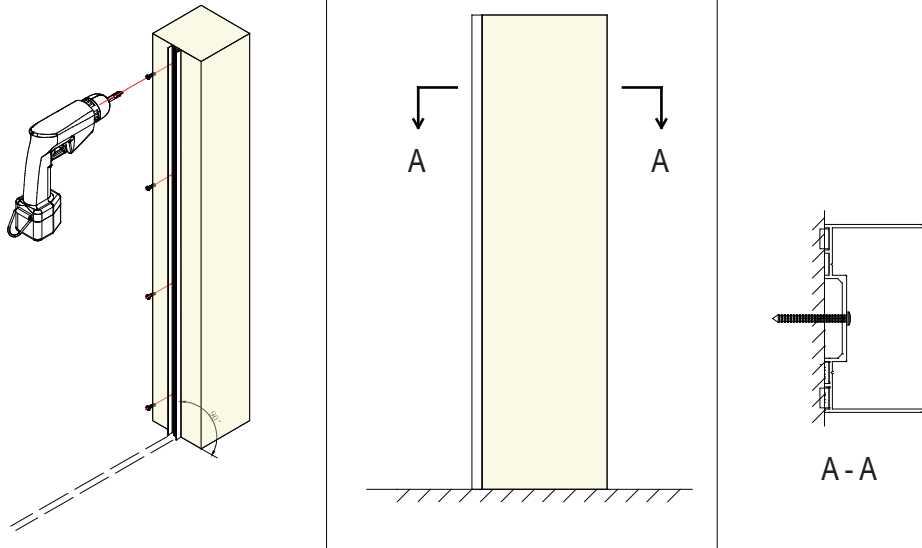

2

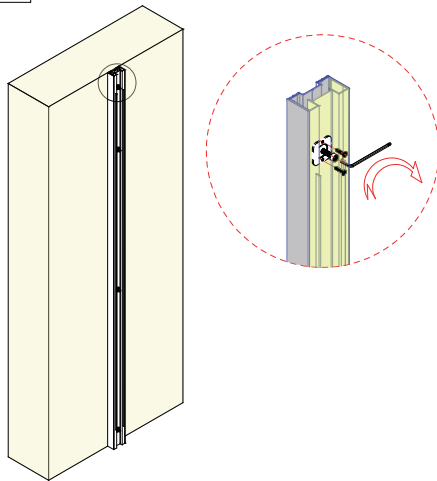

3

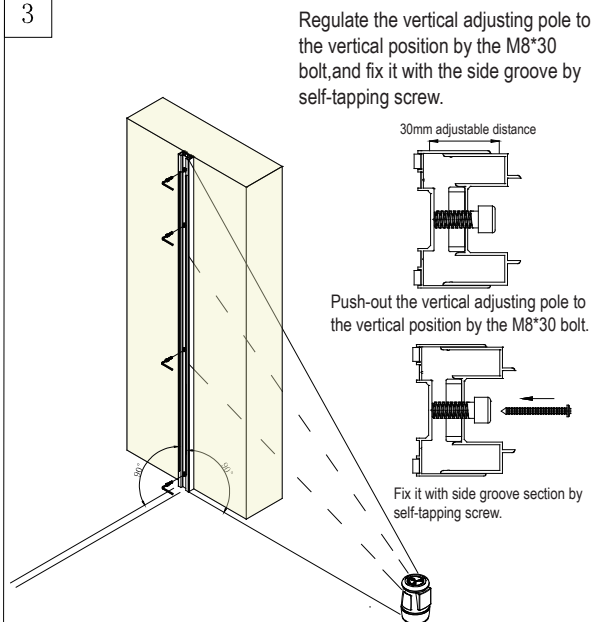

### 3.2 Top and bottom groove installation & vertical

1

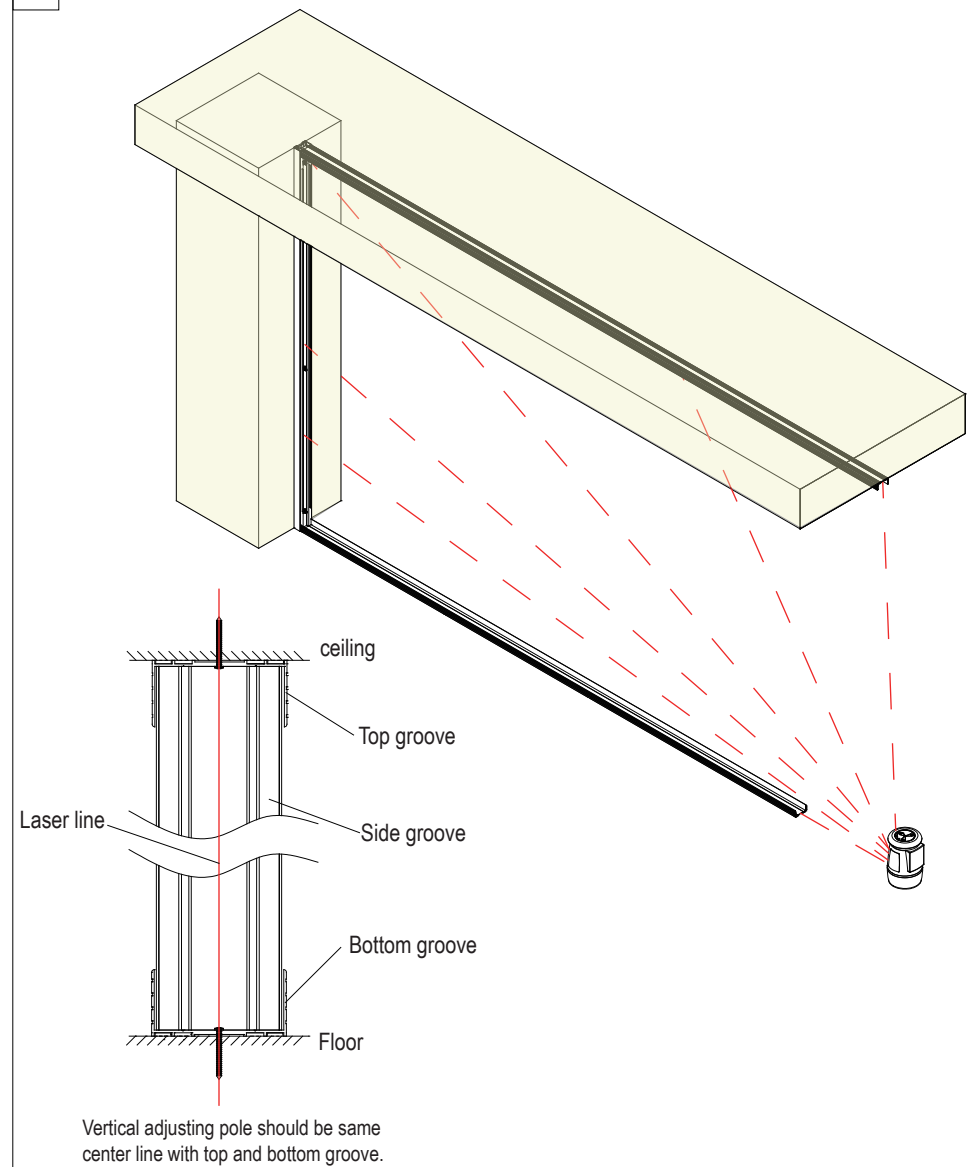

2

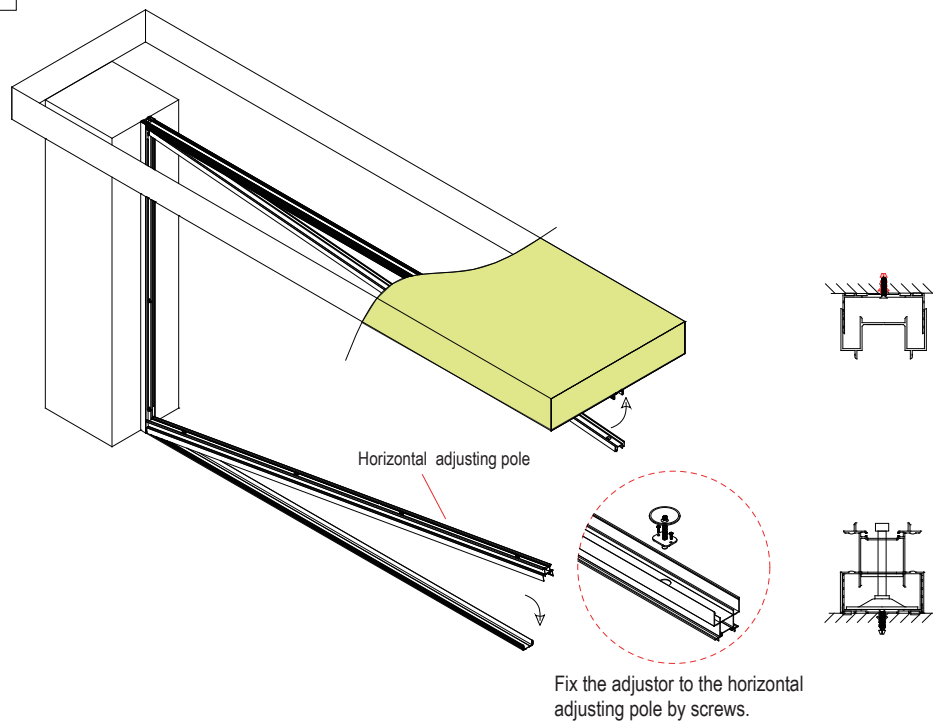

3

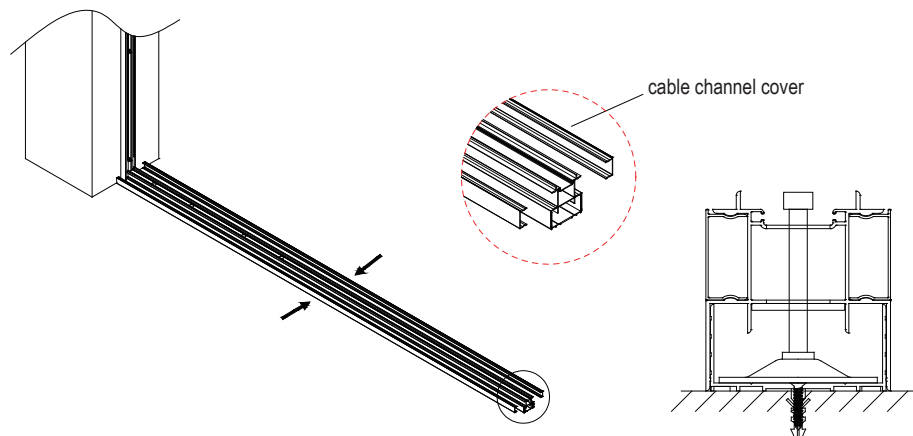

4

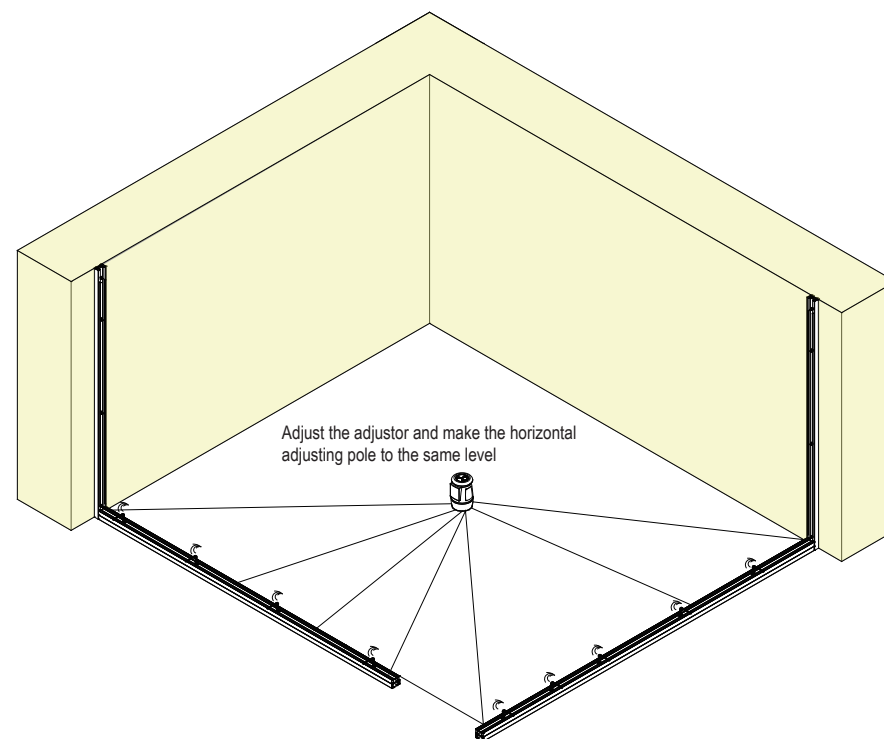

### 3.3 Corner pole installation

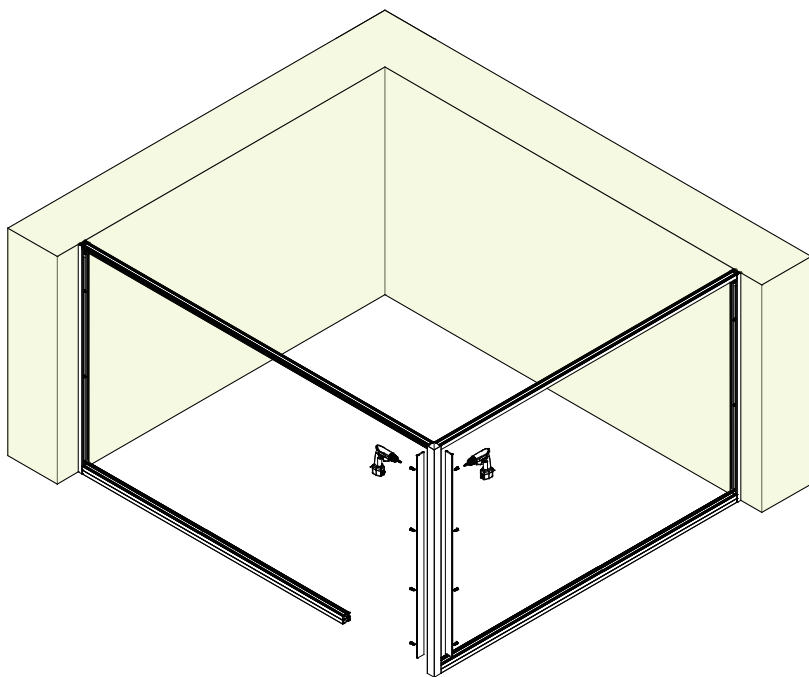

Different corner pole

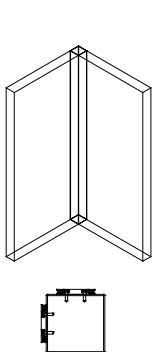

2 ways connection system

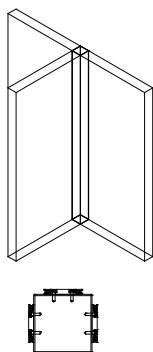

3 ways connection system

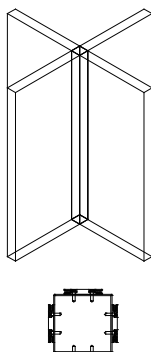

4 ways connection system

### 3.4 Horizontal panels connection

1

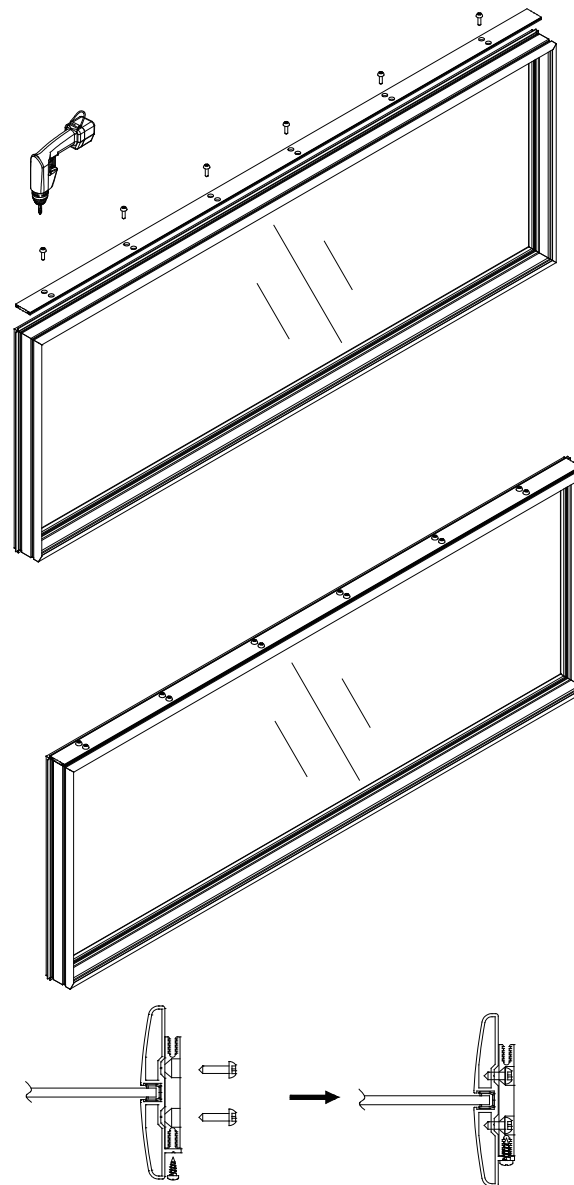

2

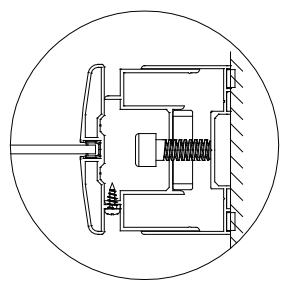
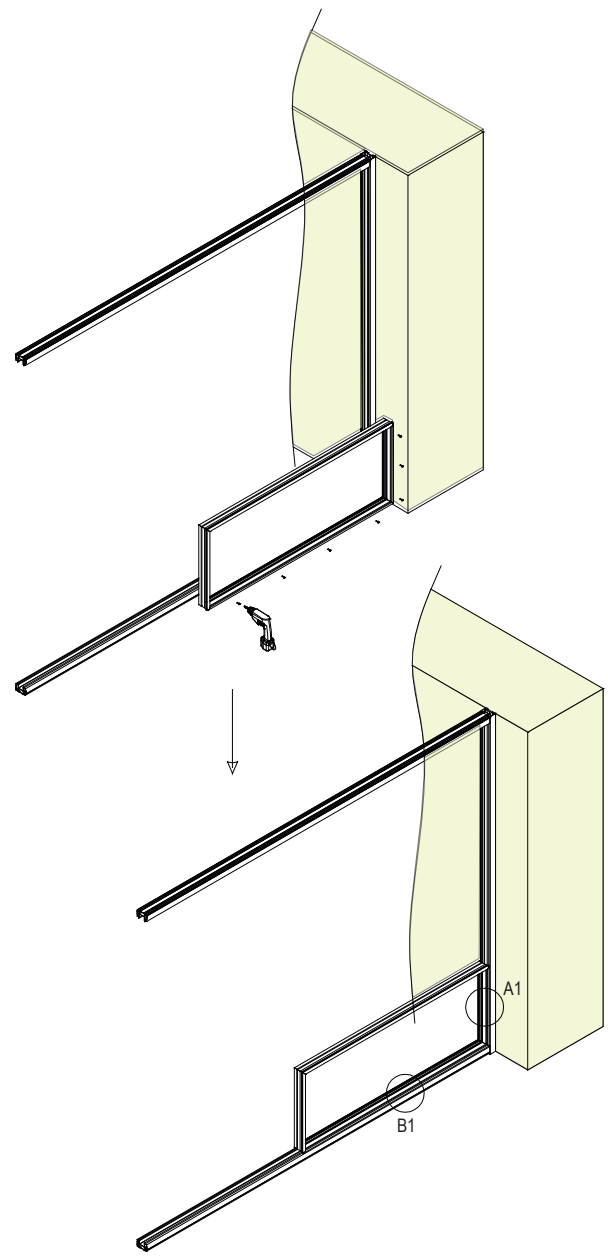

Section A1

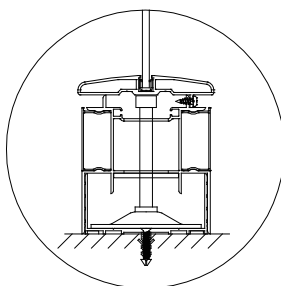

Section B1

3

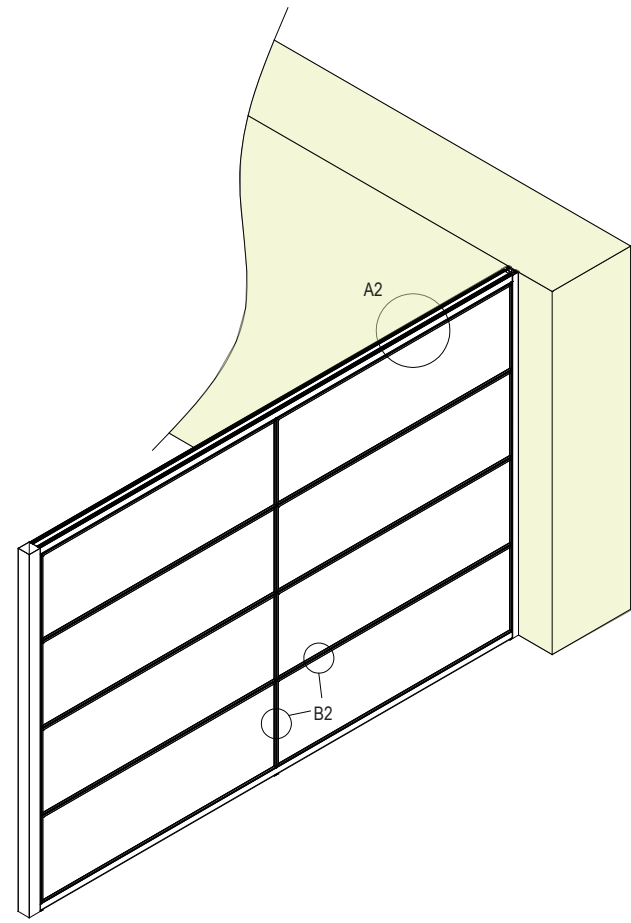

Section A2

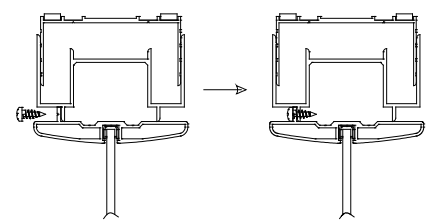

Section B2

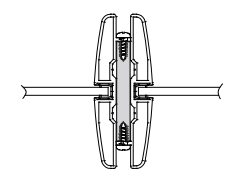

### 3.5 Vertical panels connection

1

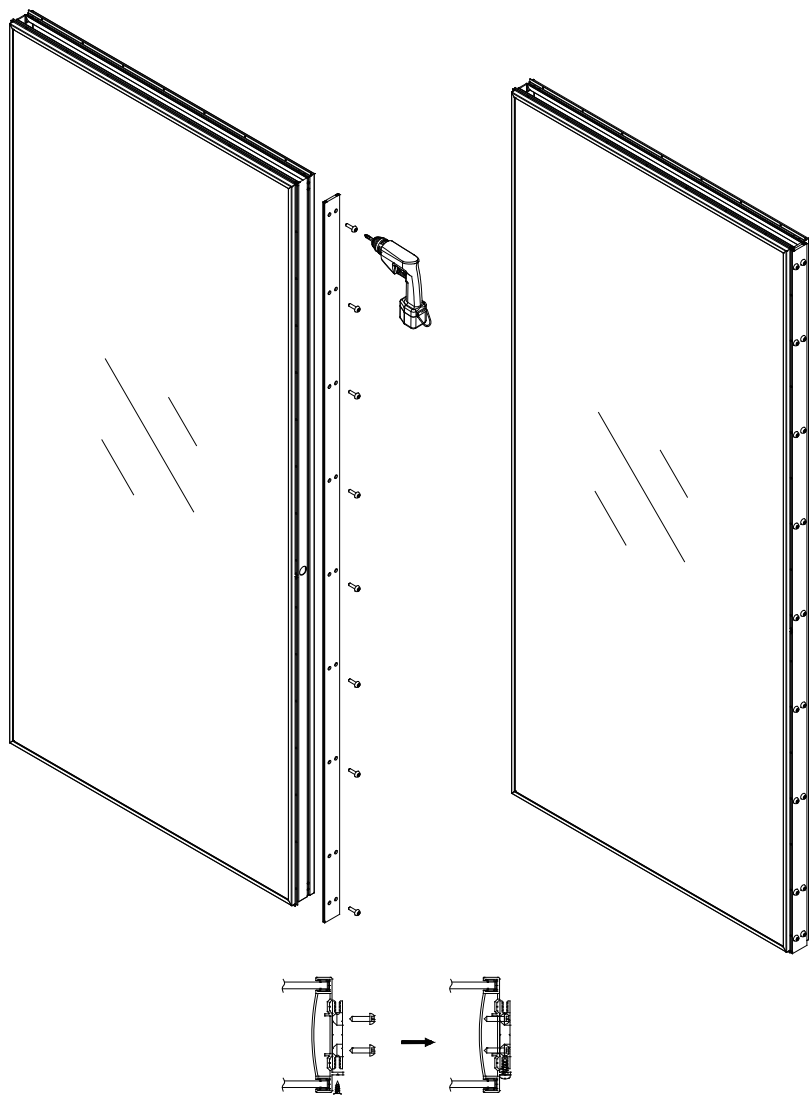

2

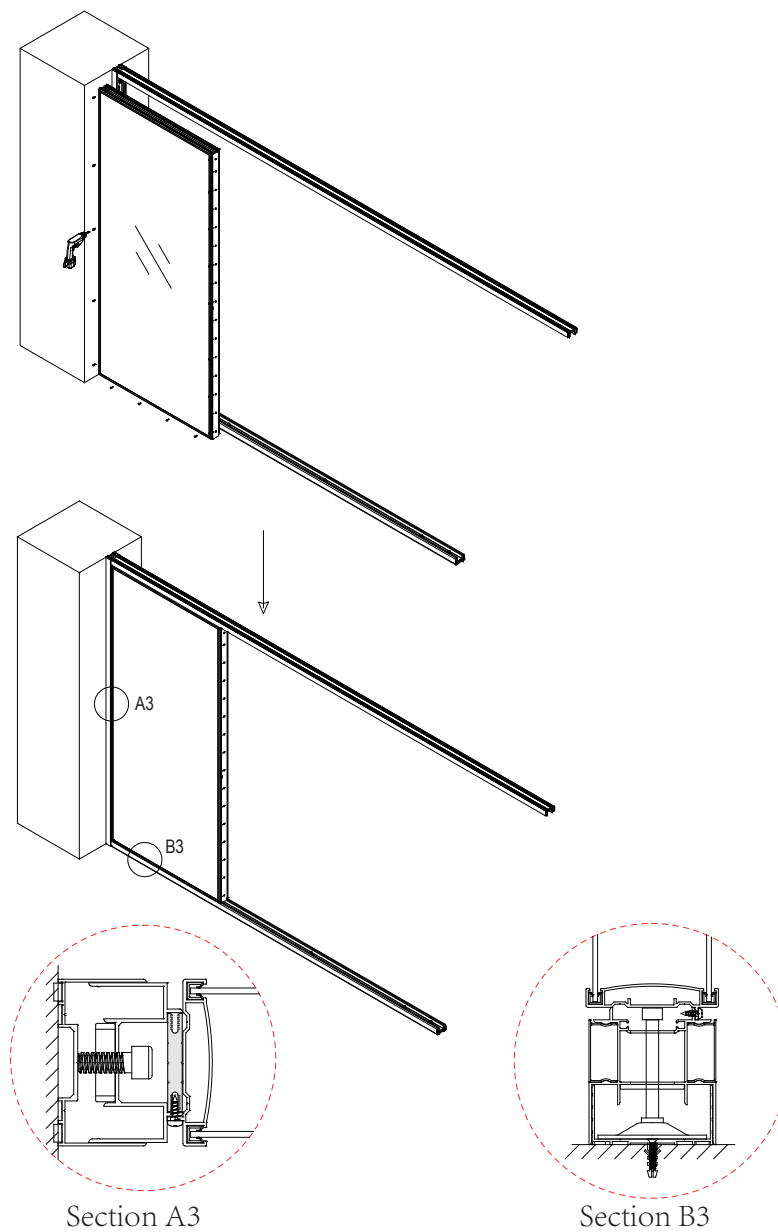

3

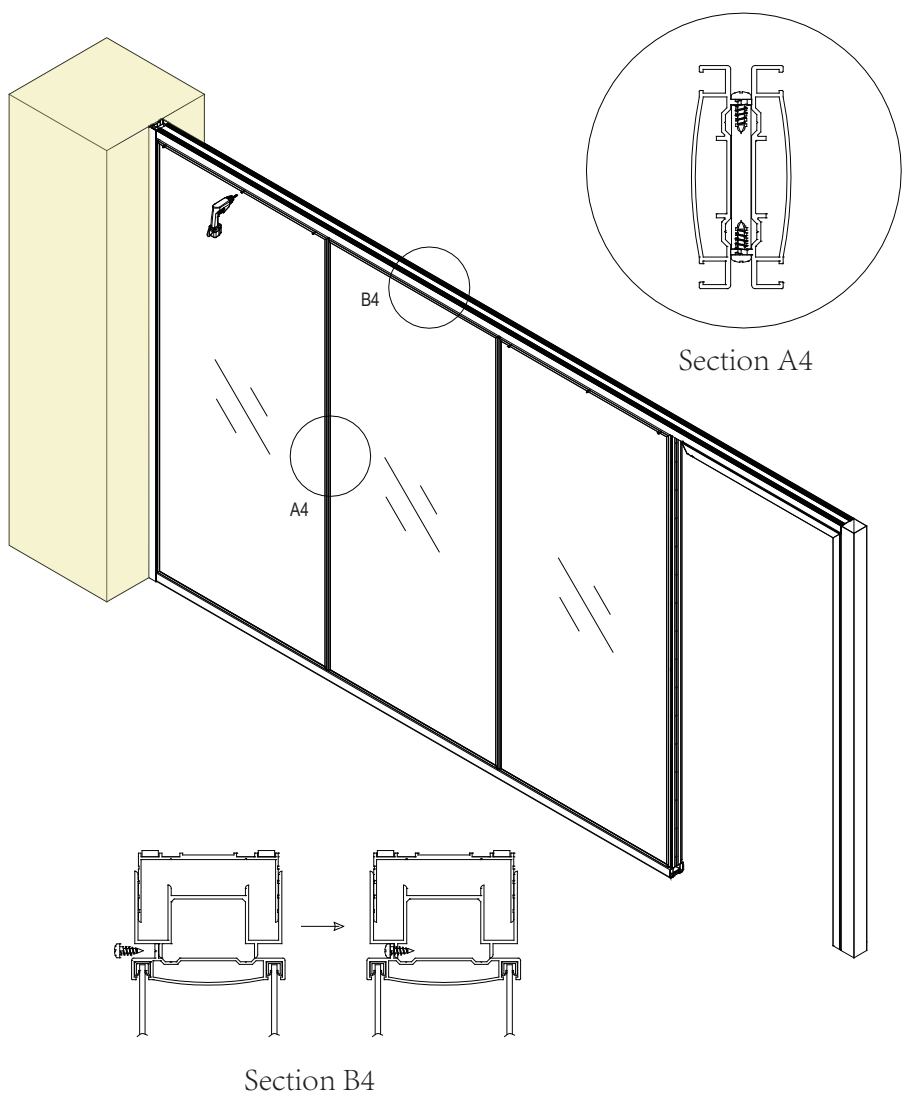

3.6 Blind installation

1

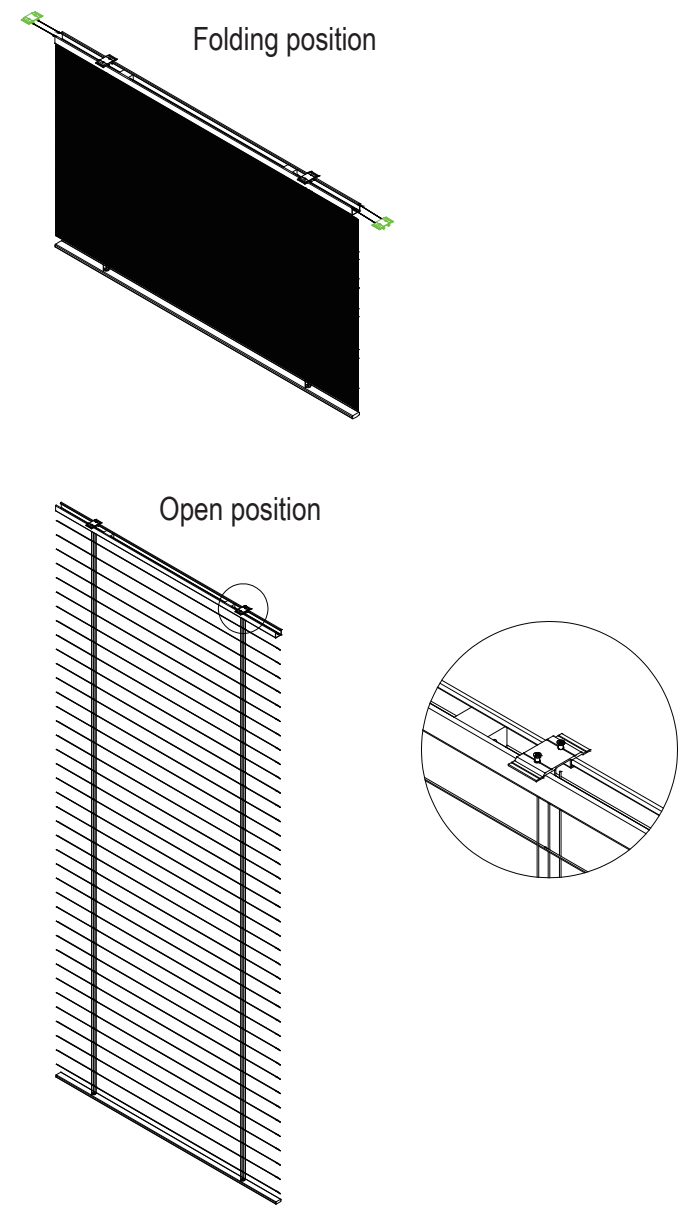

2

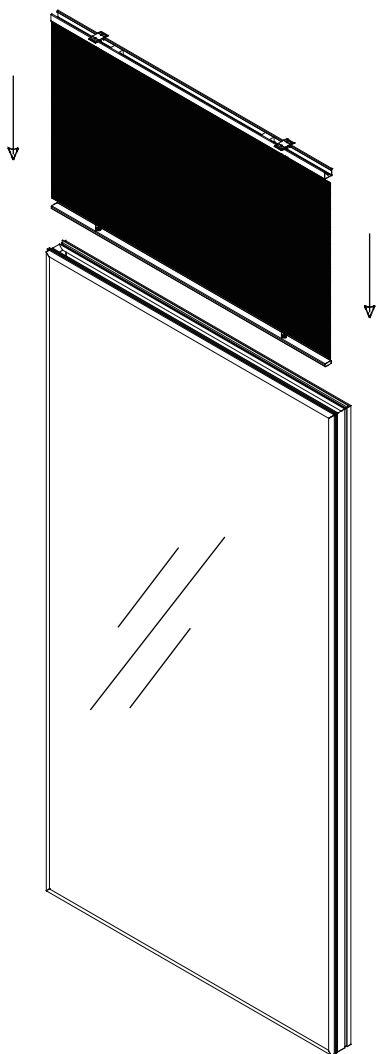

3

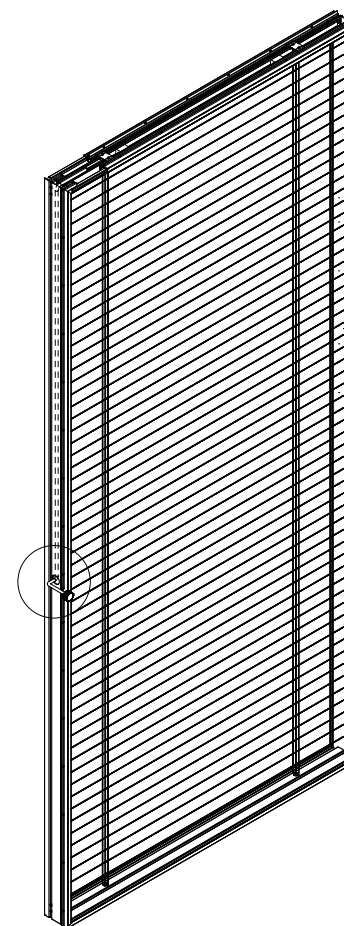
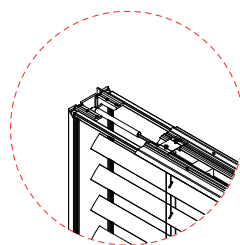
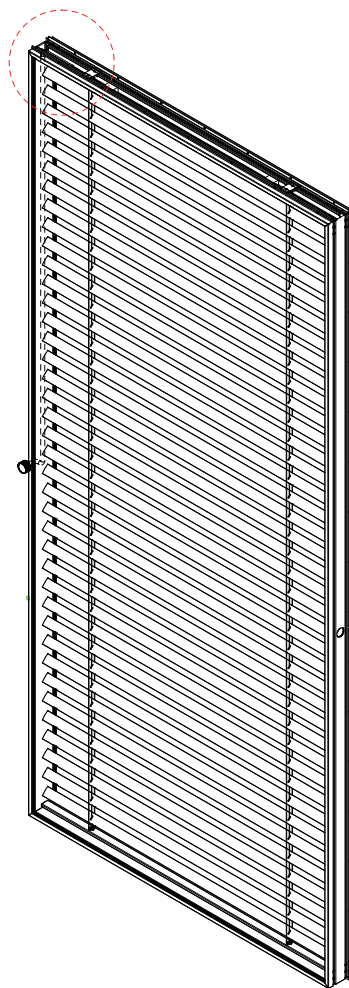

Controlled wire :

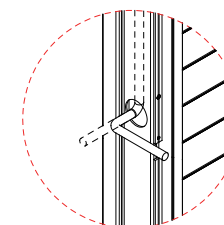
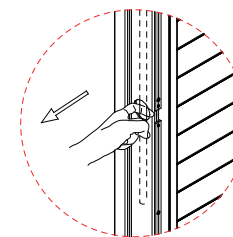

Controller :

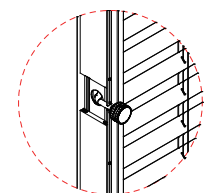
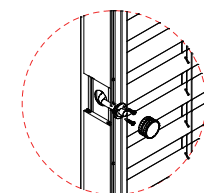

Note: Controller should not be fixed at the corner position.

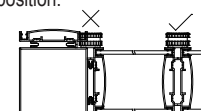

## Typical 2: Partitions not up to ceiling

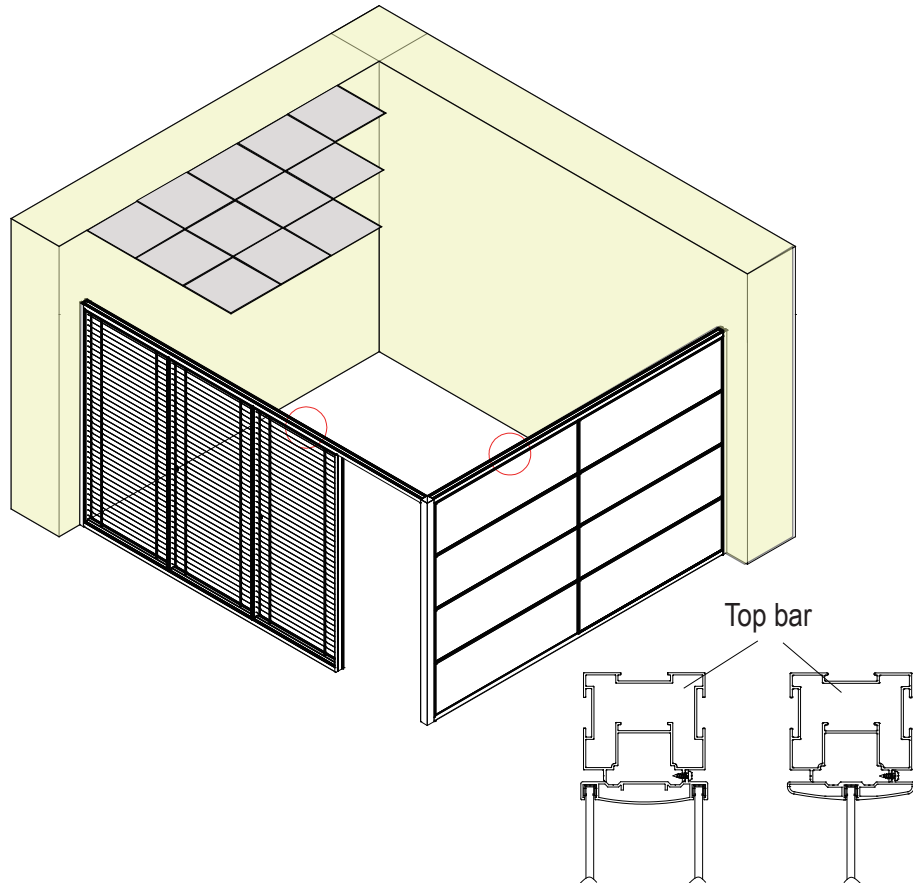

### Note:

1. The only difference is to use top bar instead of ceiling connection when the partitions are not up to ceiling.
2. Fix the bottom connection, then fix the first panel, then fix the top bar, finally fix the panels one by one.

### ① Connection between top bar and wall starter

M8\*60 round head bolt  
X 1

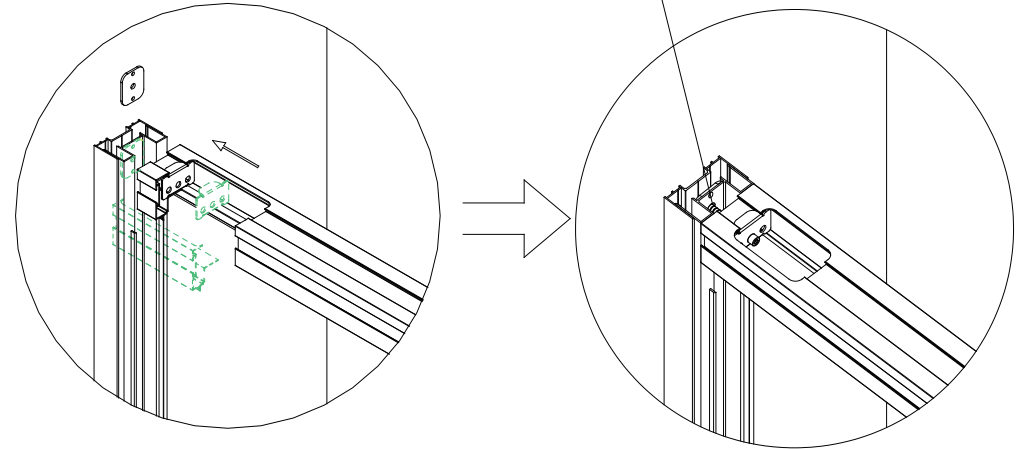

### ② Connection between top bar and corner pole

M8\*50 round head bolt  
X 2

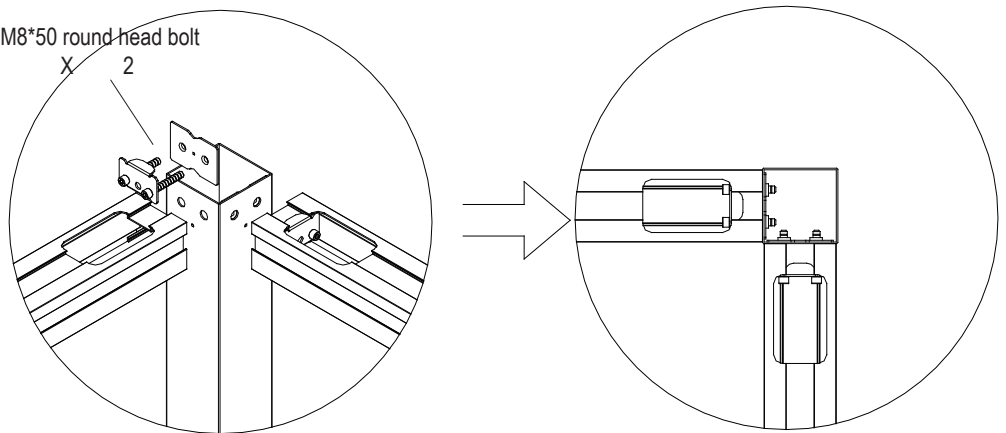

## 4 Door Illustration

### 4.1 Wood swing door illustration

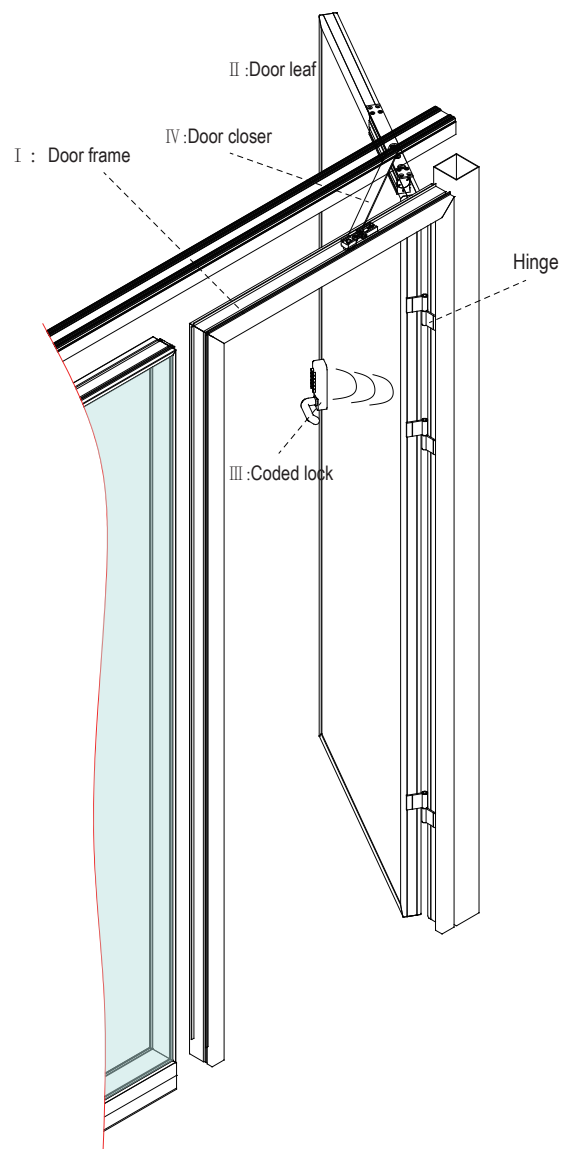

### I : Door frame installation

#### Step 1 : Up door frame installation

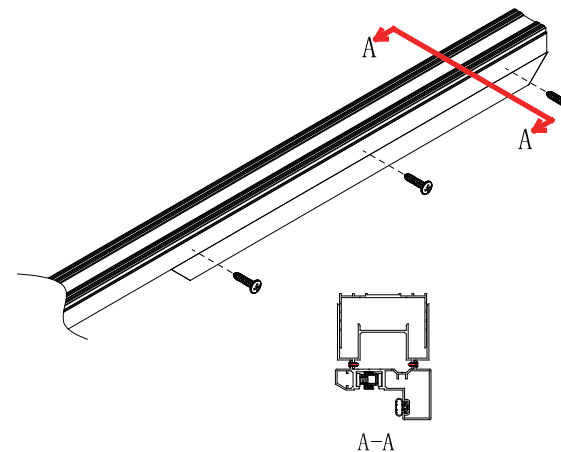

Remark:

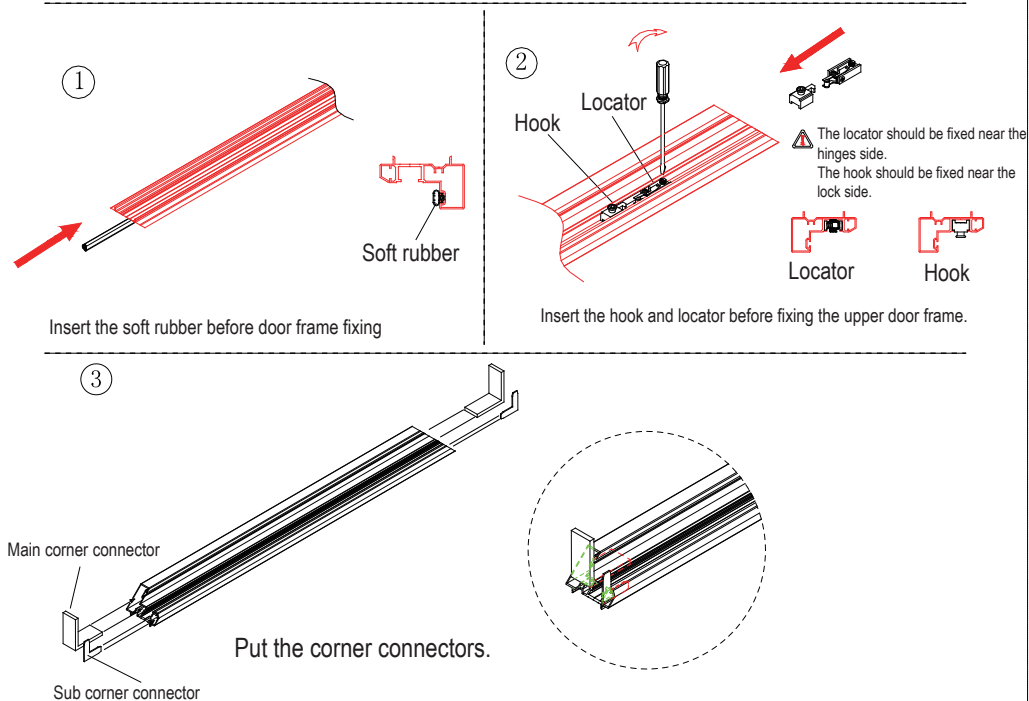

## Step 2: Lock side door frame installation

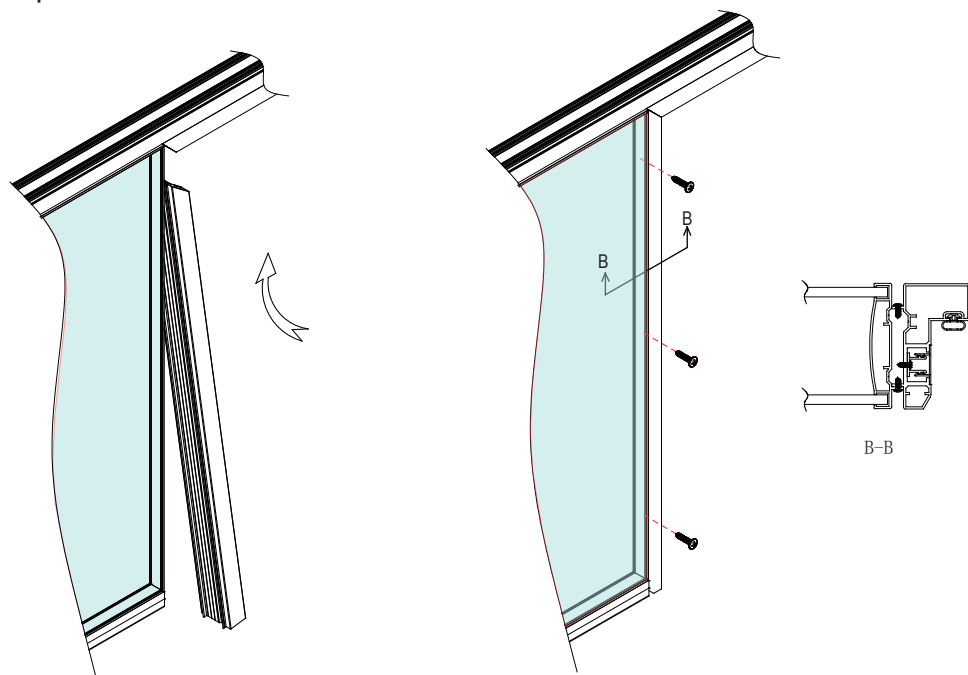

Remark:

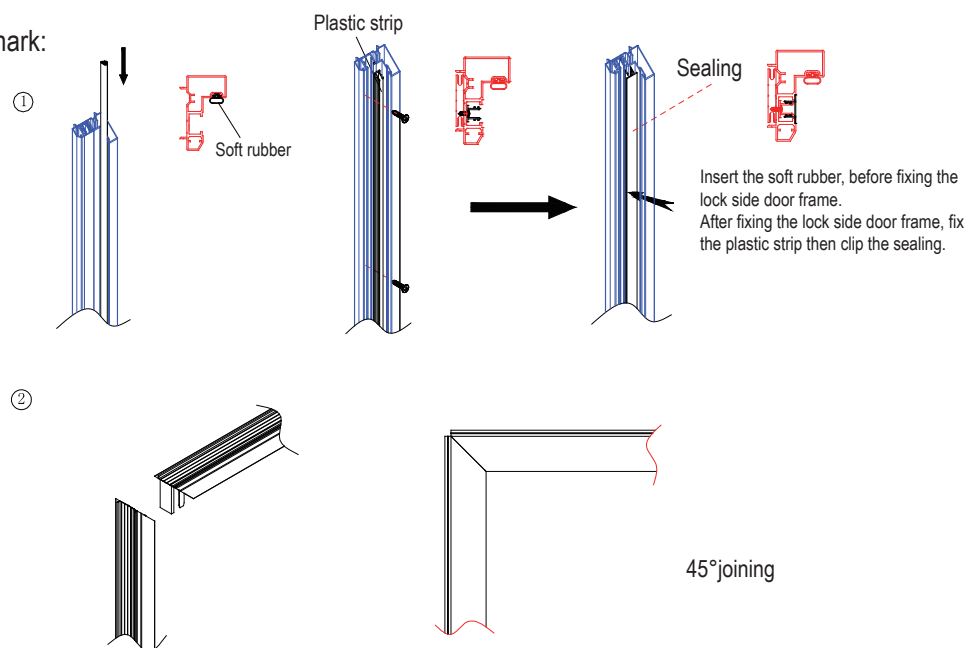

## Step 3: Hinge side door frame installation

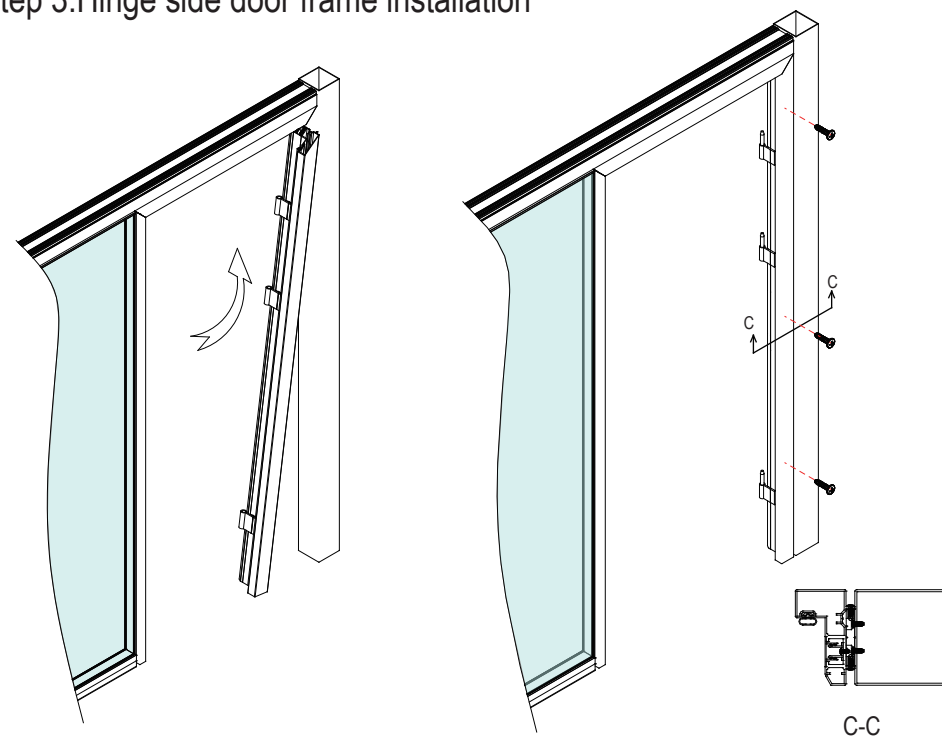

Remark:

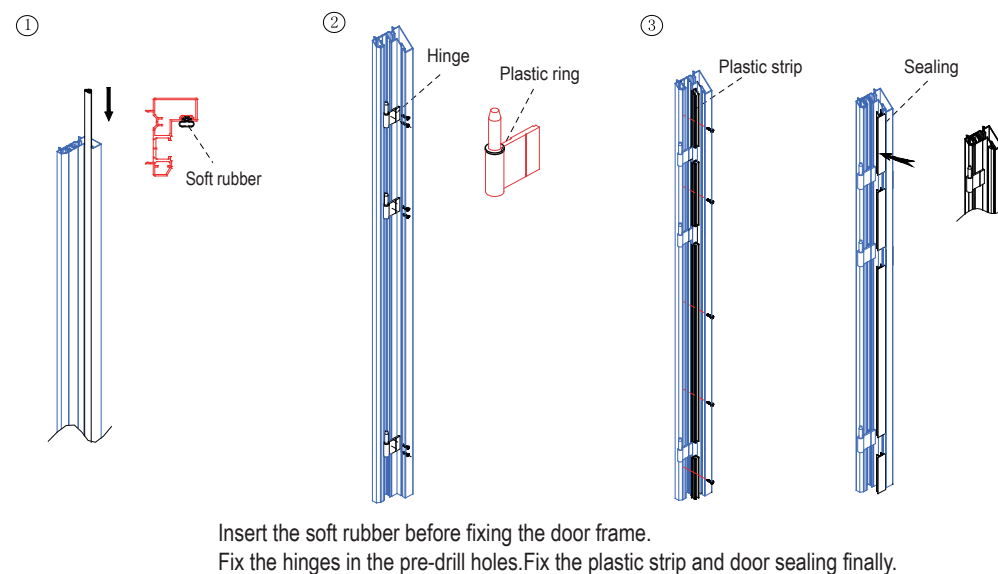

## II : Door leaf installation

Remark:

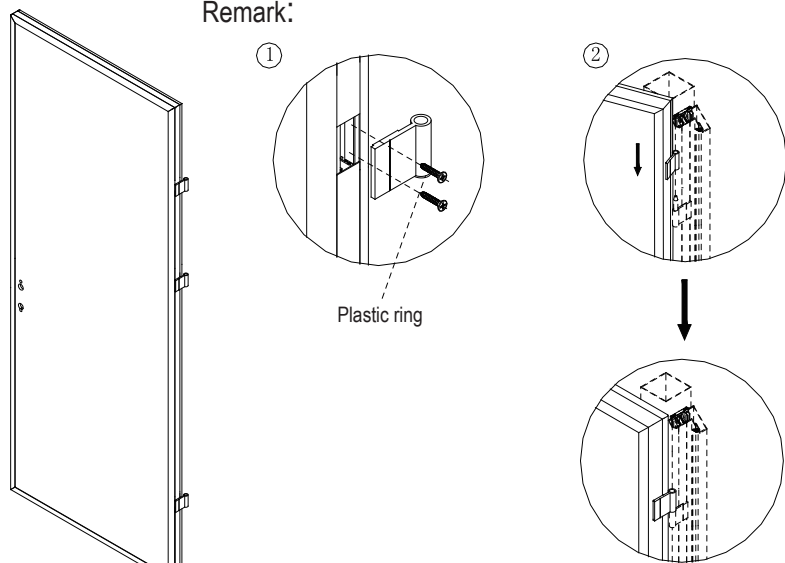

Join the two hinges together to fix the door leaf.

Image :

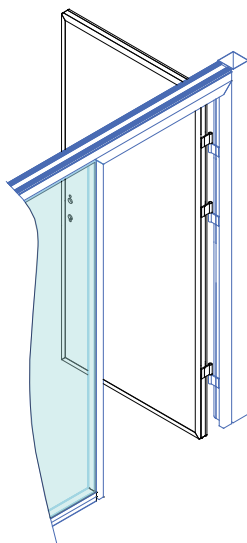

## III : Coded lock installation

Coded lock break-down :

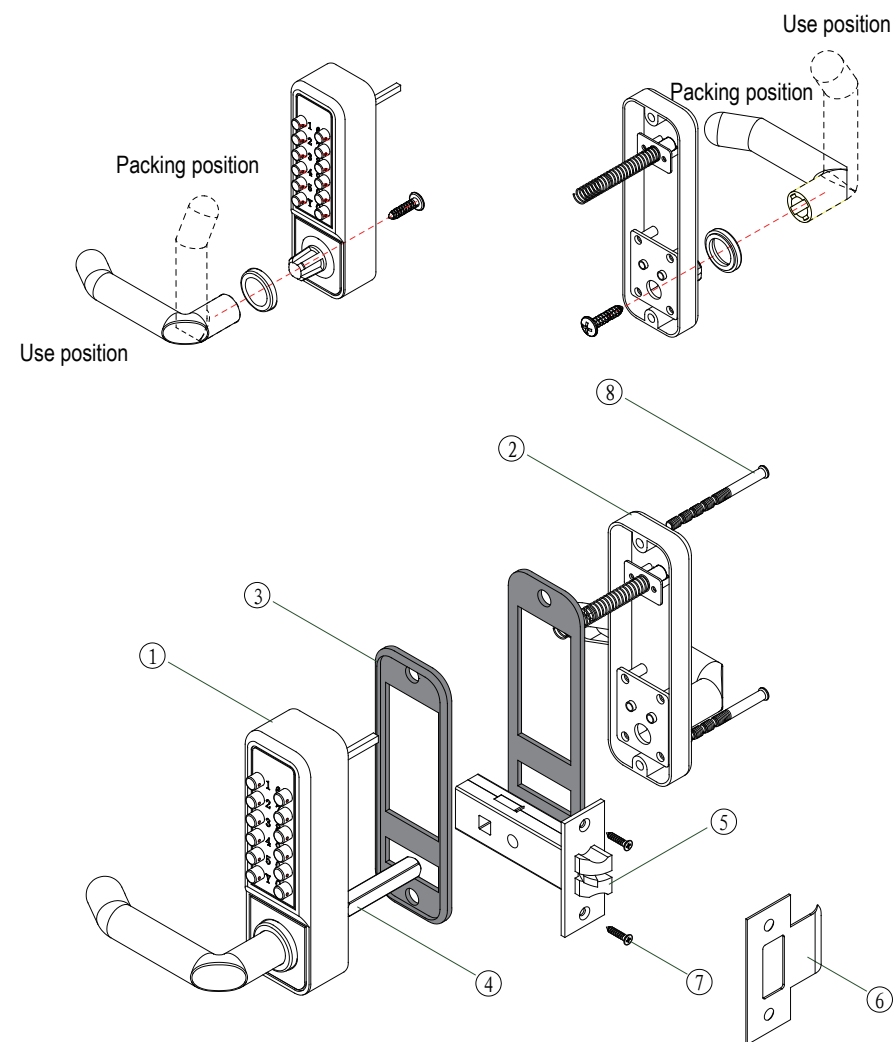

# Components list:

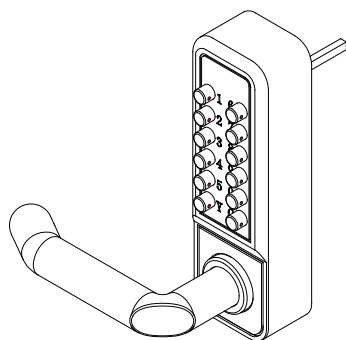

1: External lock

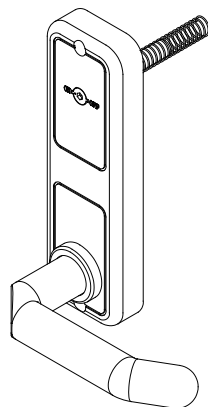

2: Internal lock

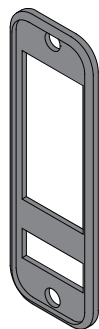

× 2  
3: Plastic mat

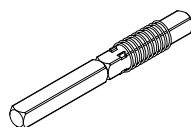

4: Axis

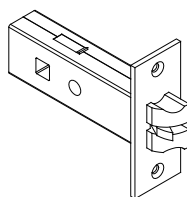

5: Strike plate

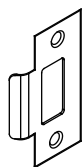

6: Stopper



× 4  
7: Self-tapping screw



× 2  
8: Long screw

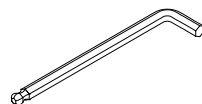

CRV-3mm  
9: Allen key

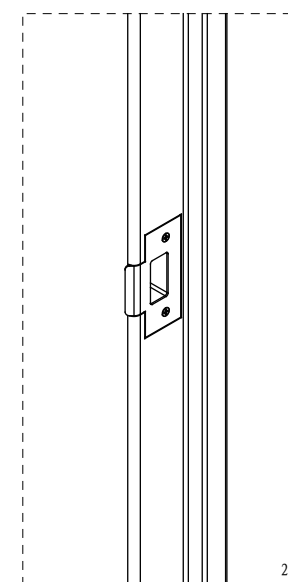
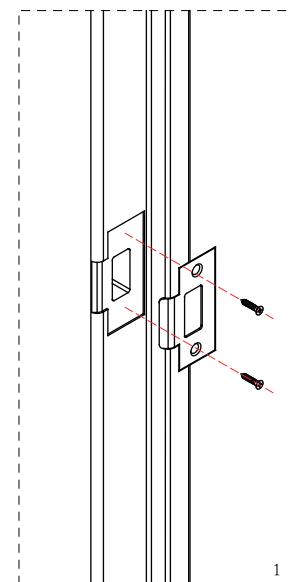
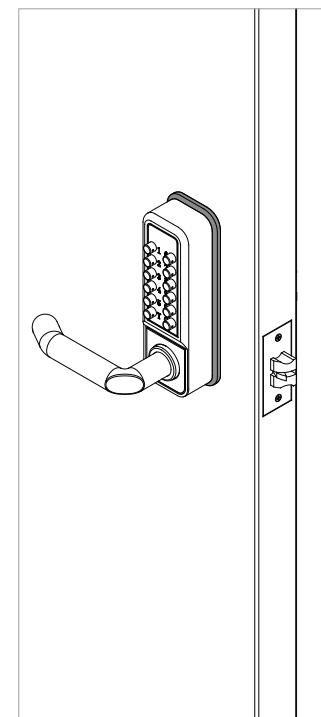
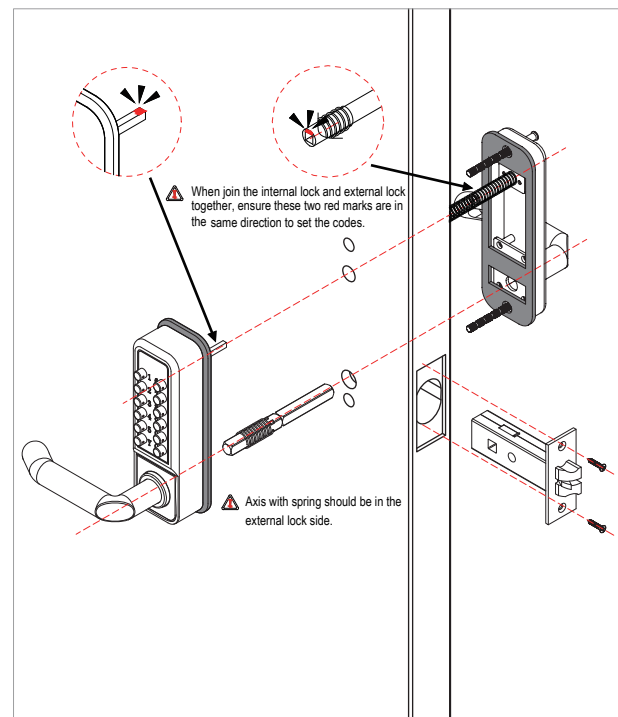

# How to set the codes for the coded lock?

Step 1:

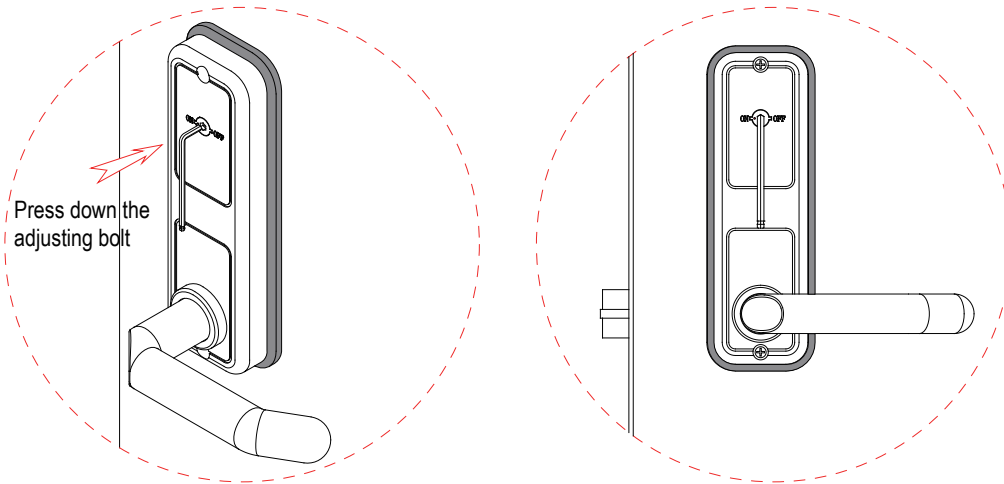

Step 2:

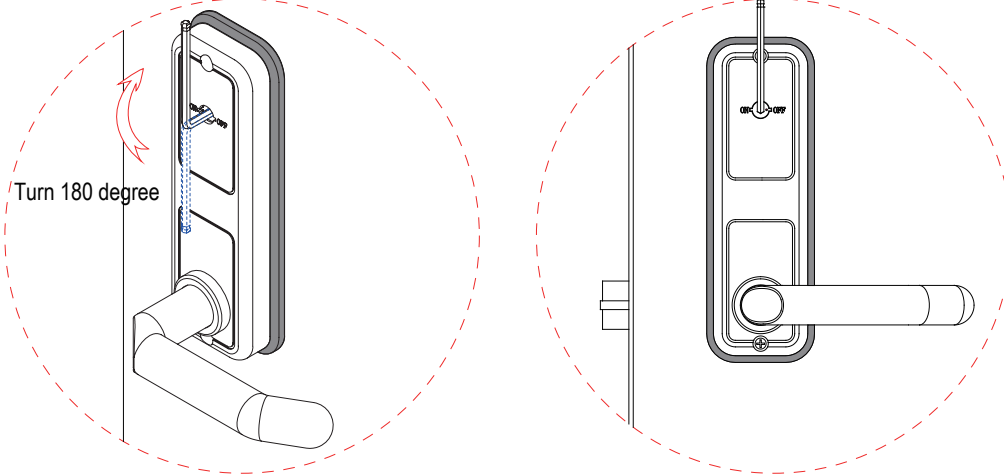

Turn the red point from "on" to "off"

Select the numbers, and turn it 180°, make all the red points in the same horizontal position.

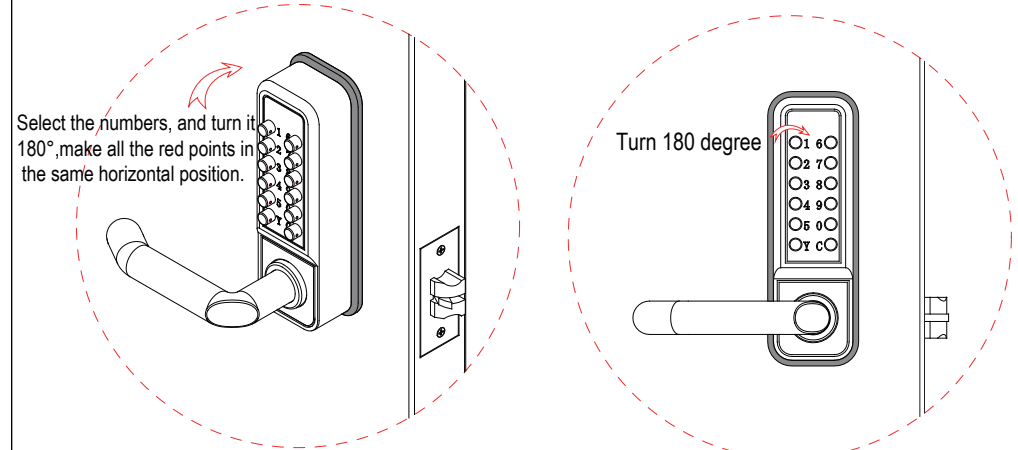

Step 4:

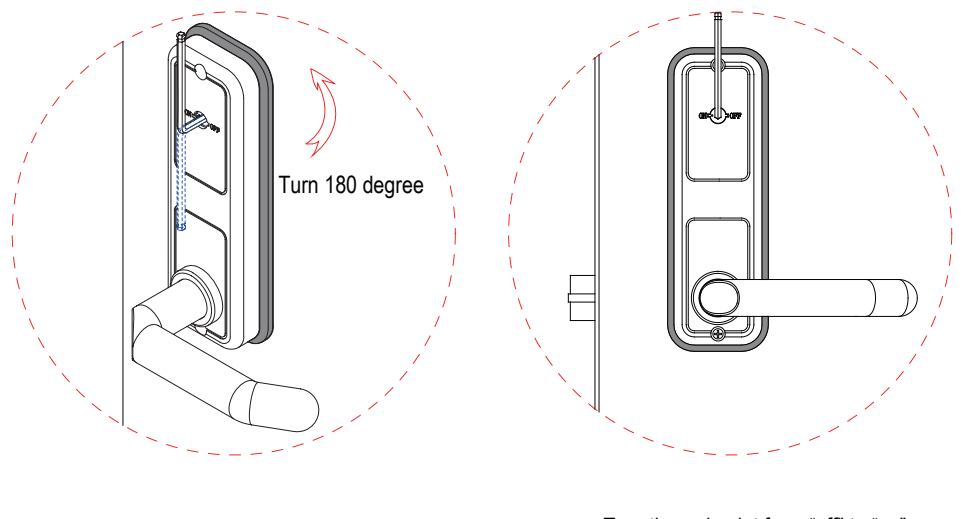

Turn the red point from "off" to "on"

## IV:Door closer installation

Components list:

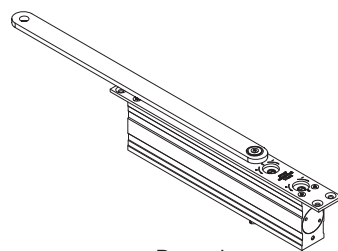
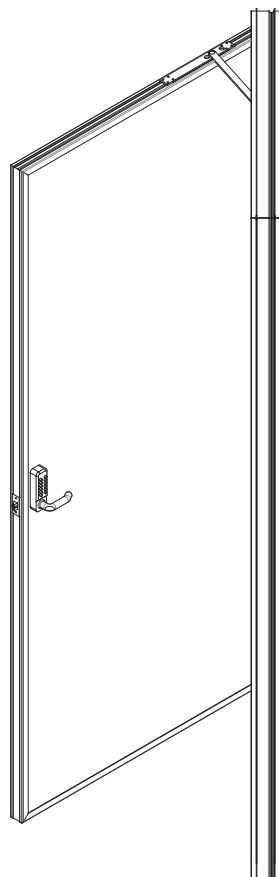

Door closer  
X 1



Hook  
X 1

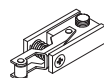

Locator  
X 1



screw  
X 4

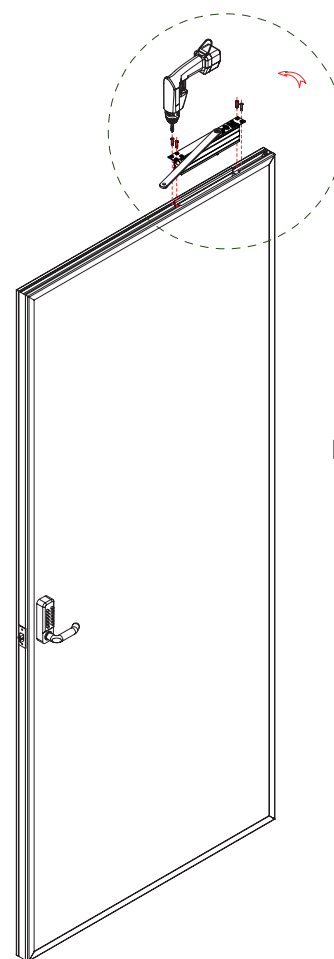

Fix the door closer with the door leaf

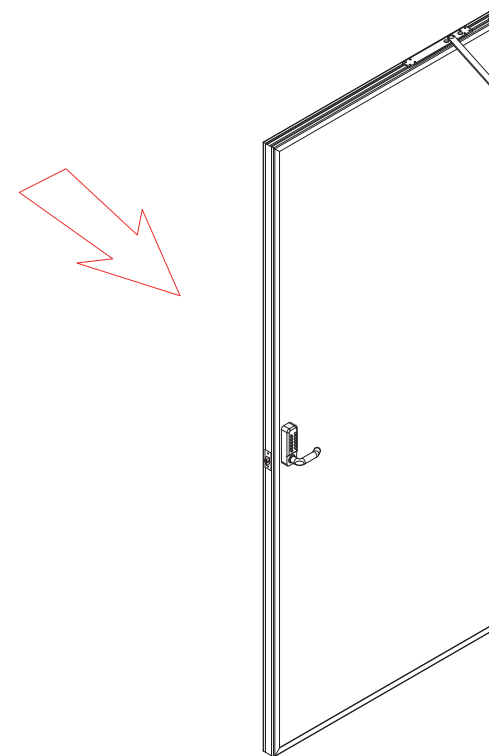
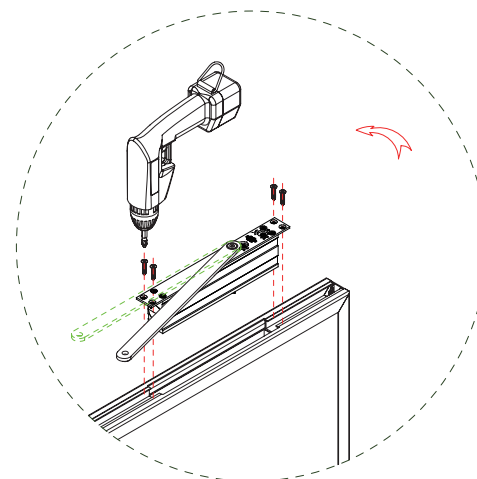

Insert the hook and locator before fixing  
the upper door frame.

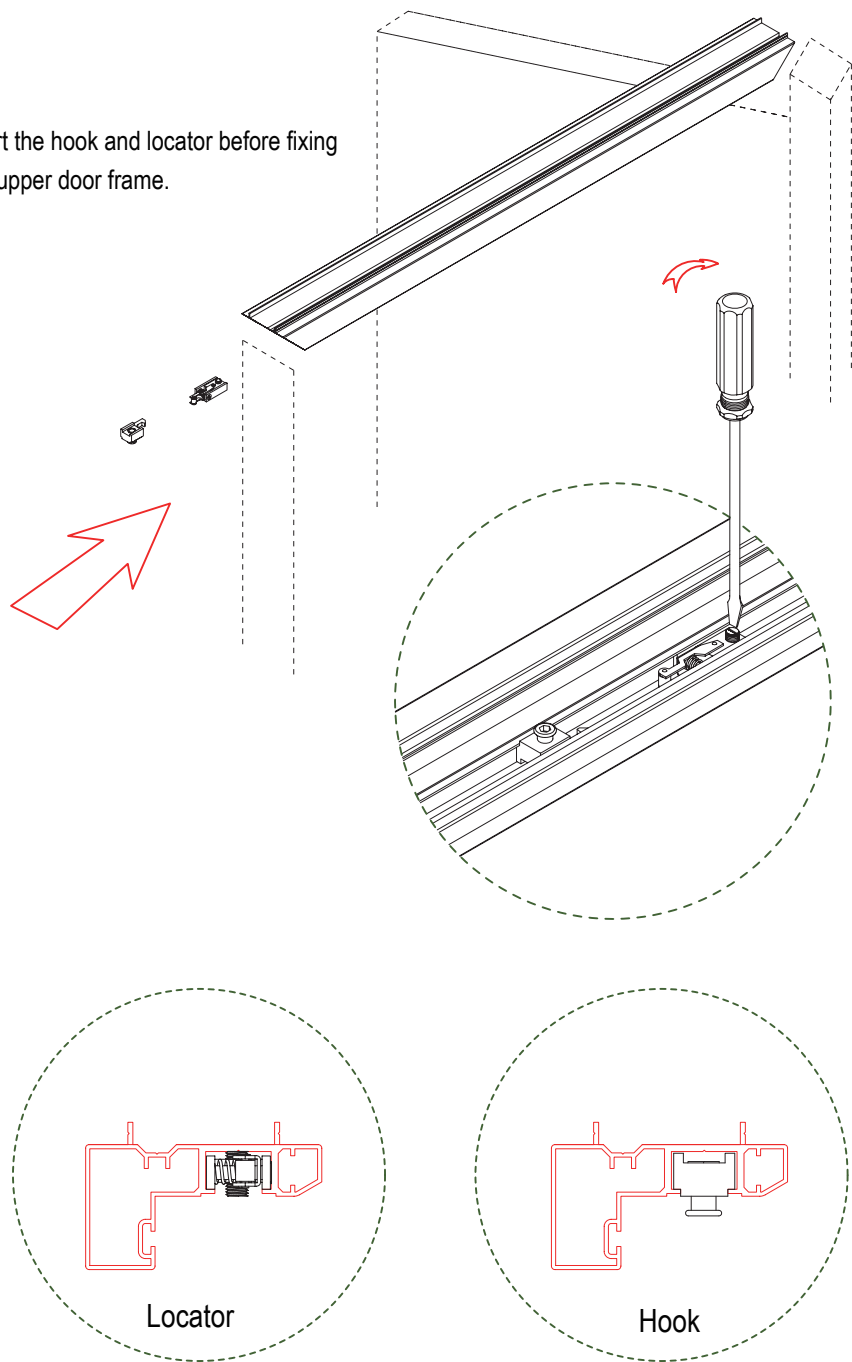

Uplift the door leaf, and join the hinges together

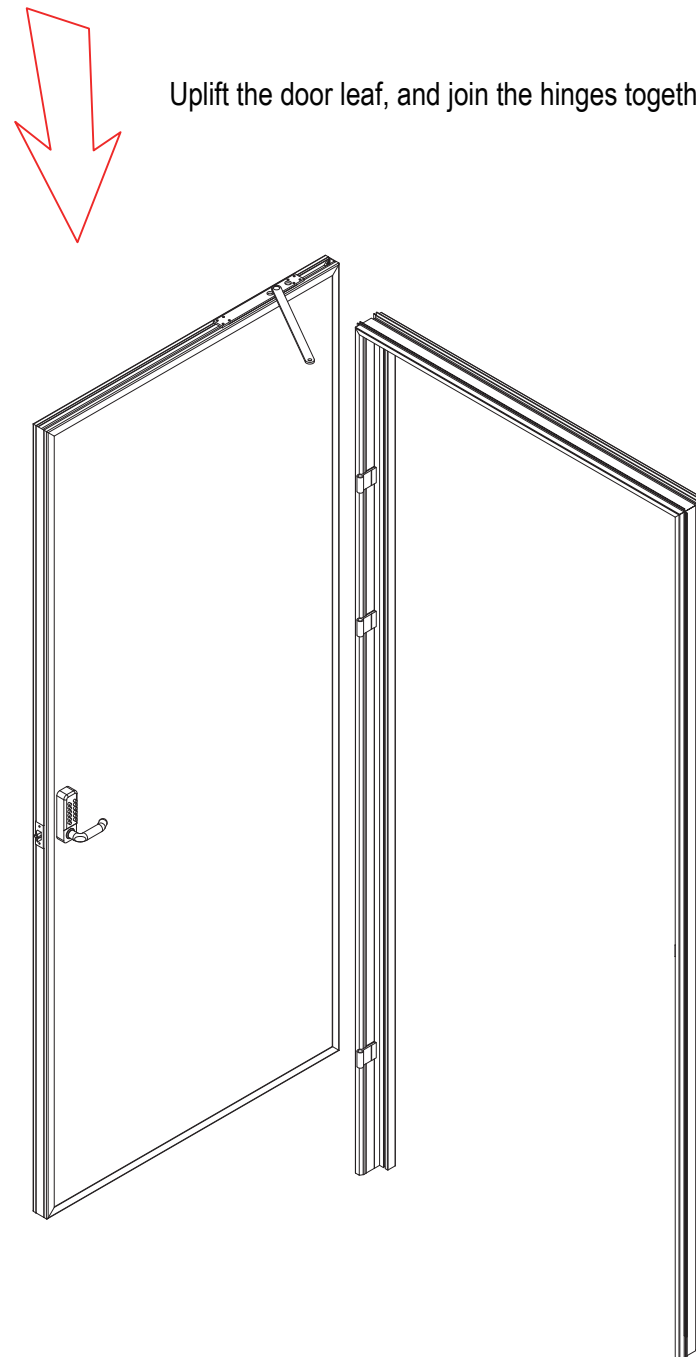

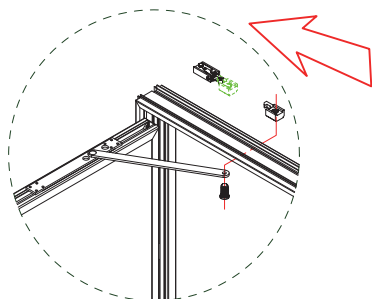
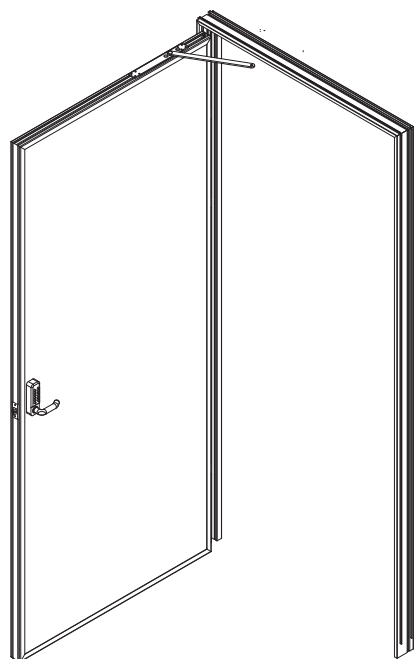

Loose the screw, fix the bracket with the hook.

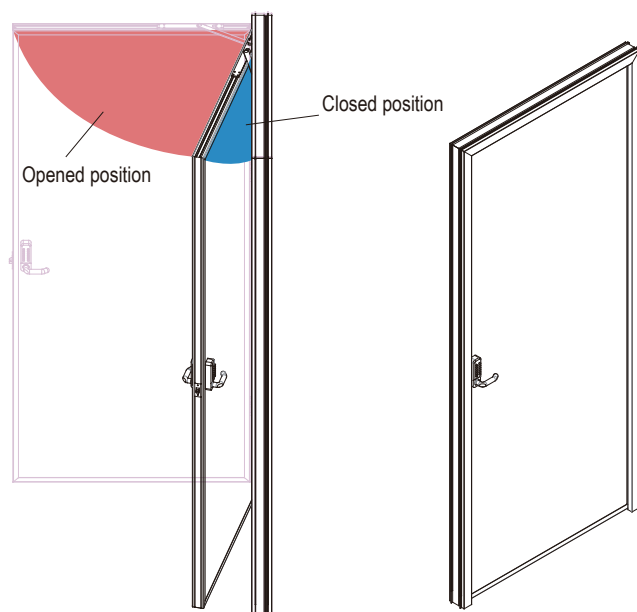

## How to adjust the door closer?

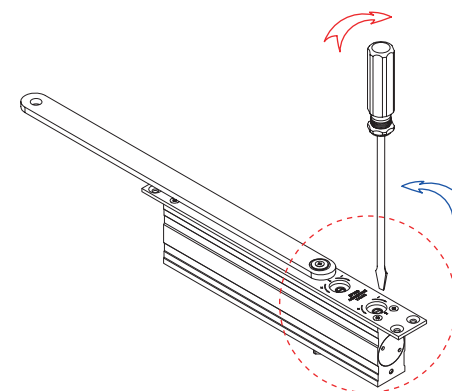

Counterclockwise  
means tight

Counterclockwise  
means tight

To control step 1

Clockwise  
means loose

Clockwise  
means loose

To control step 2

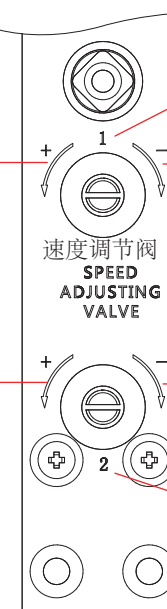

Please do careful when adjuste the screw,  
the Hydraulic oil may leakage if you  
adjuste too much !

## 4.2 Glass swing door illustration

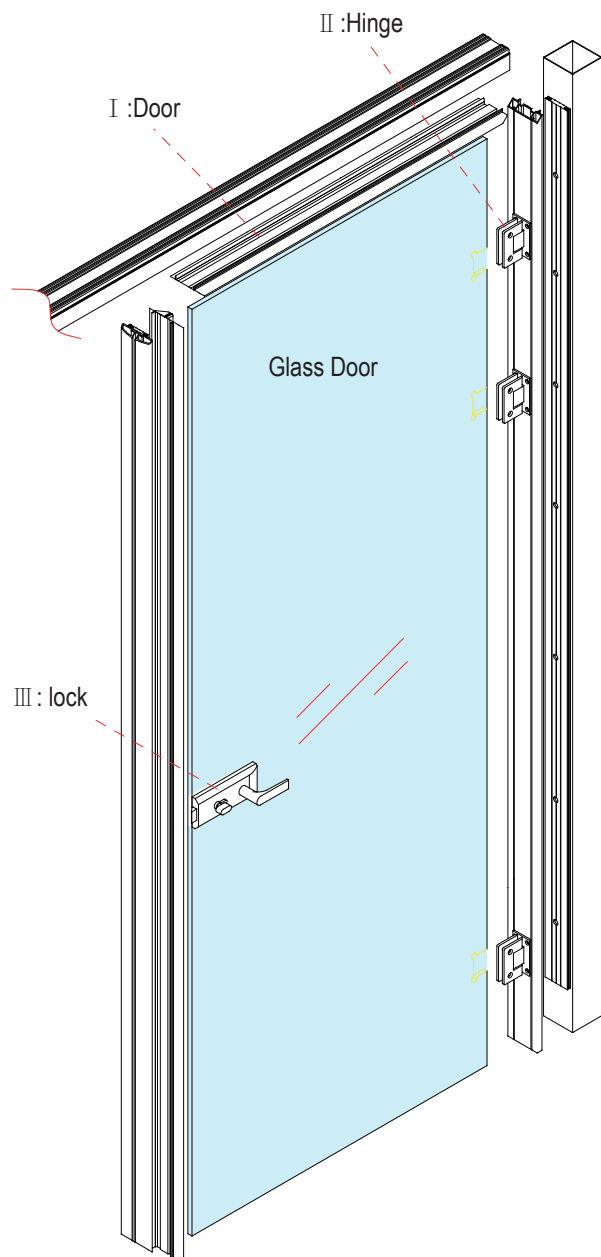

## I : Door frame installation

### Step 1: Up door frame installation

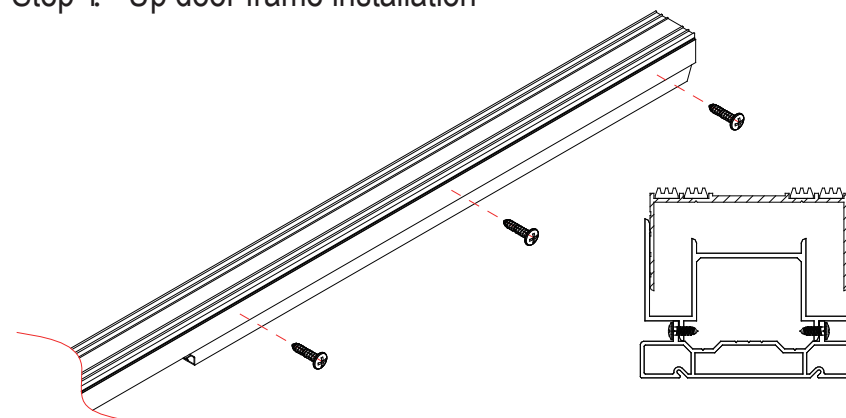

### Step 2 : Lock side door frame installation

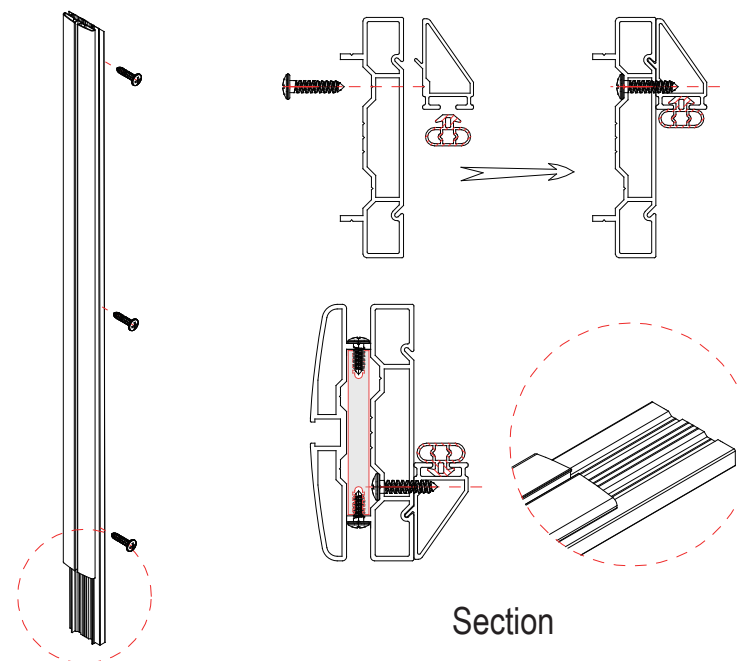

### Step 3:Hinge side door frame installation

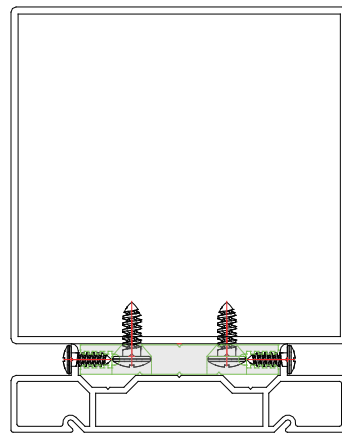
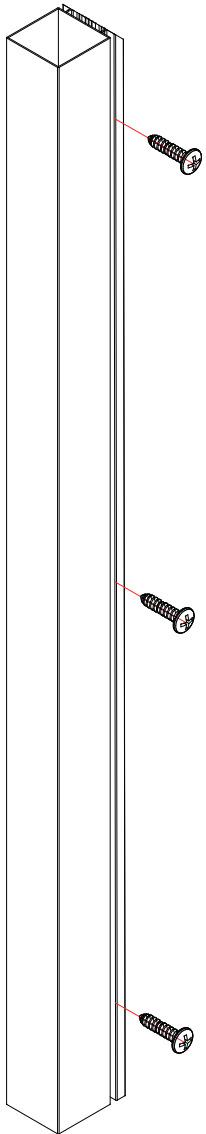

Section

### 45°joining:

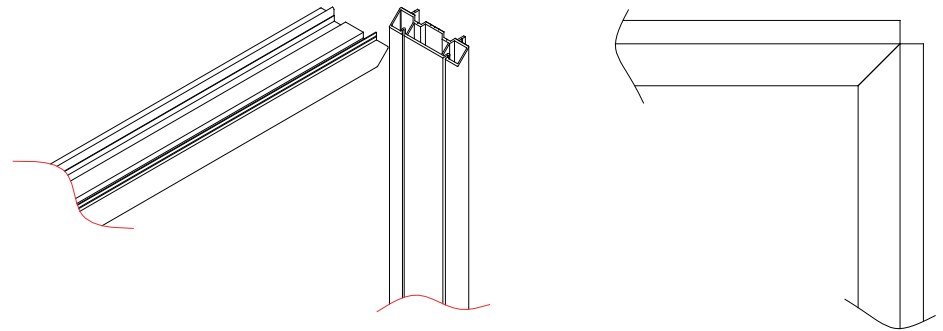

## II: Hinge installation

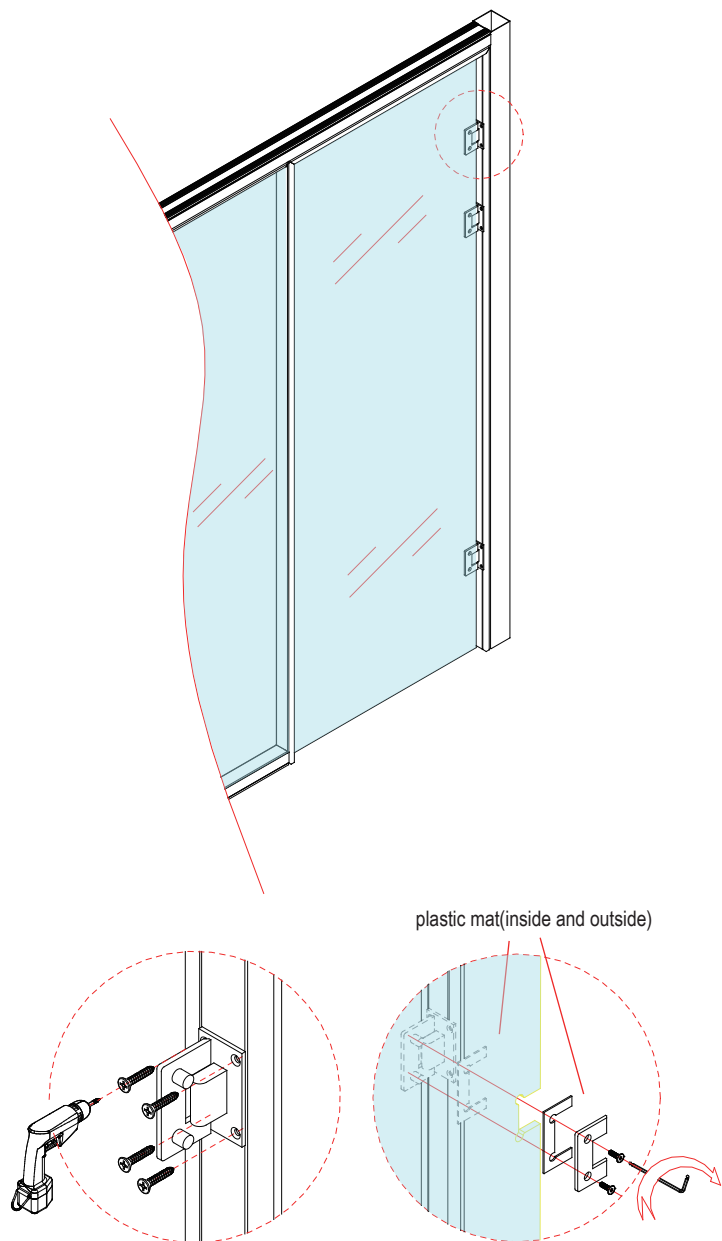

## III: Lock installation

### Step 1: Lock body installation

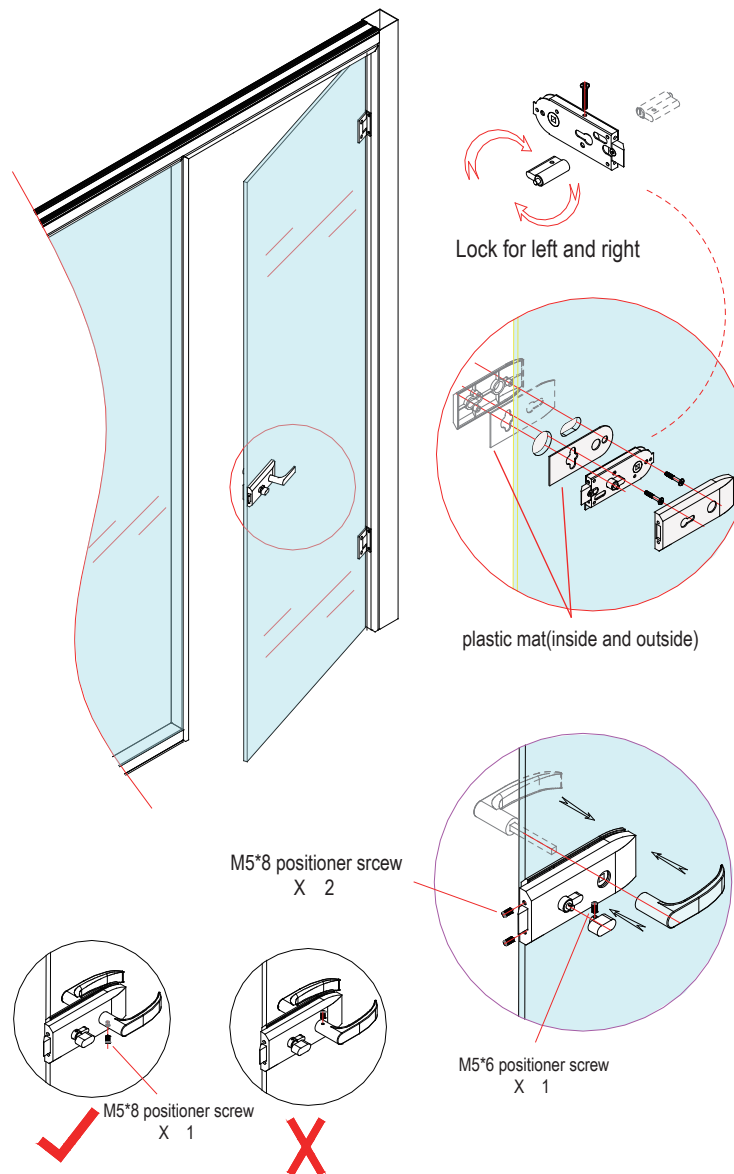

### Step 2: Lock mat installation

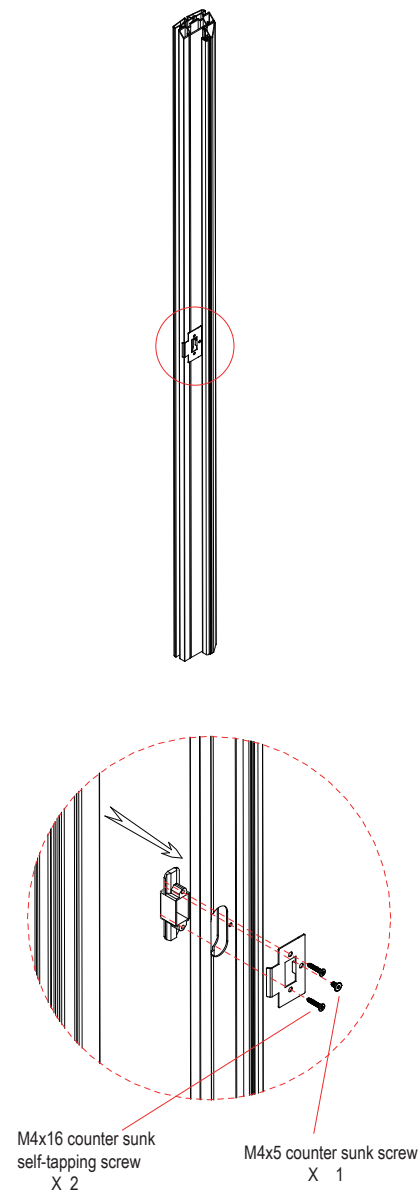

# 4.3

## Glass sliding door illustration

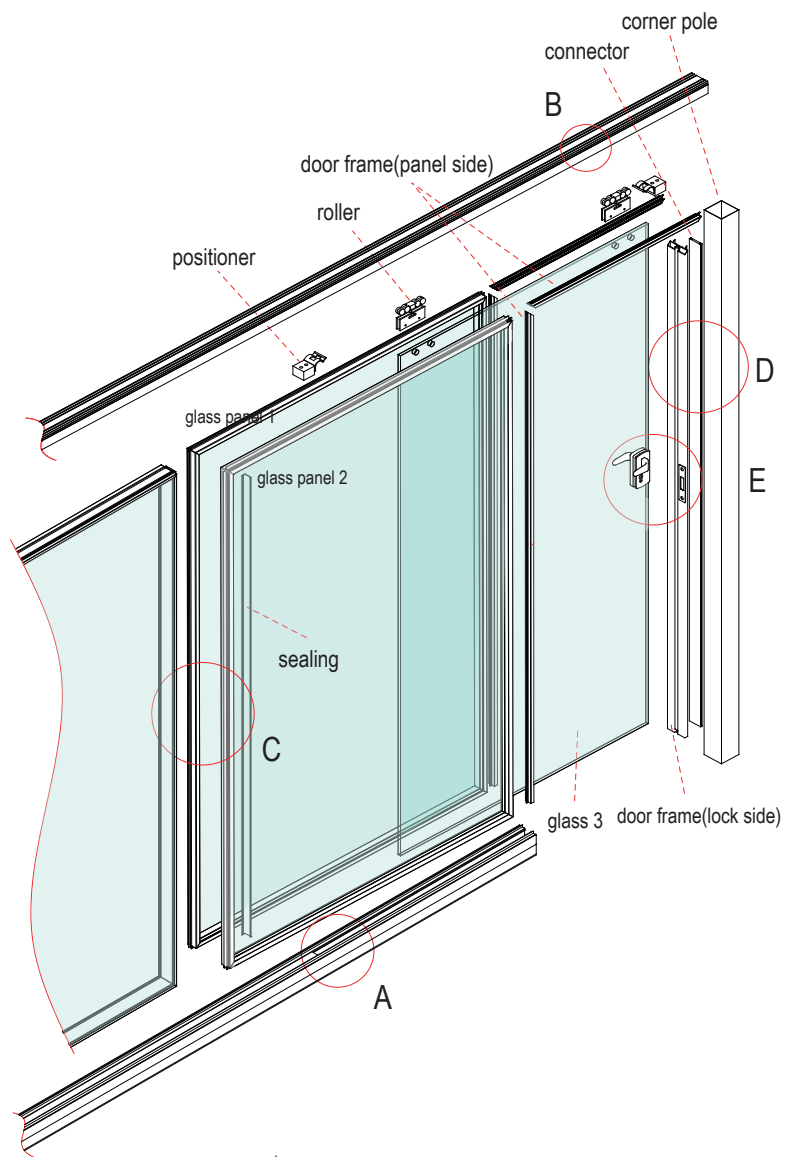

Note: ★ pay special attention

### A bottom channel assembling

Step 1

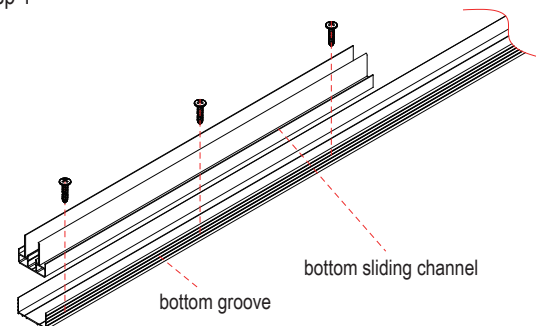

Step 2

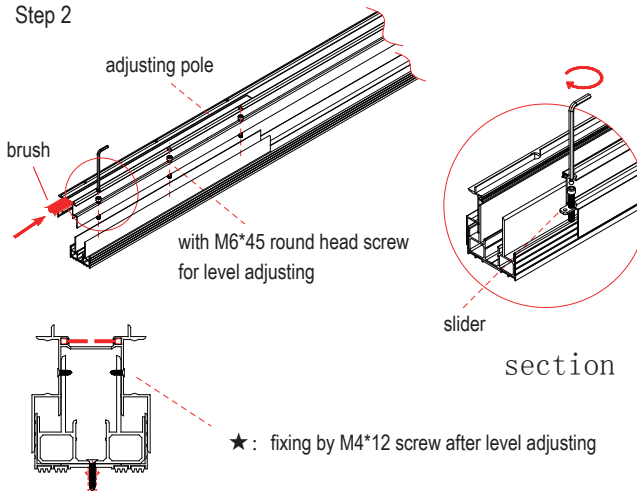

M4\*30 counter-sunk screw with plastic insert

Step 3

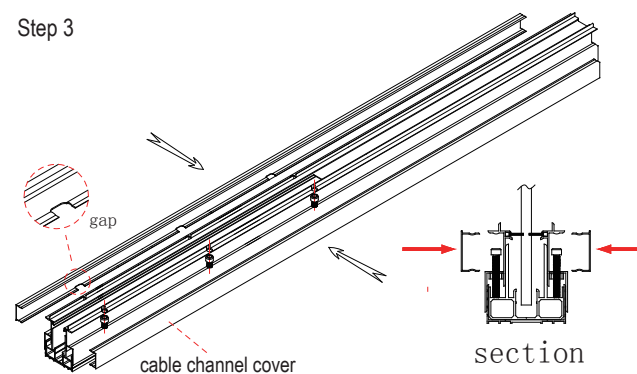

### B top channel assembling:

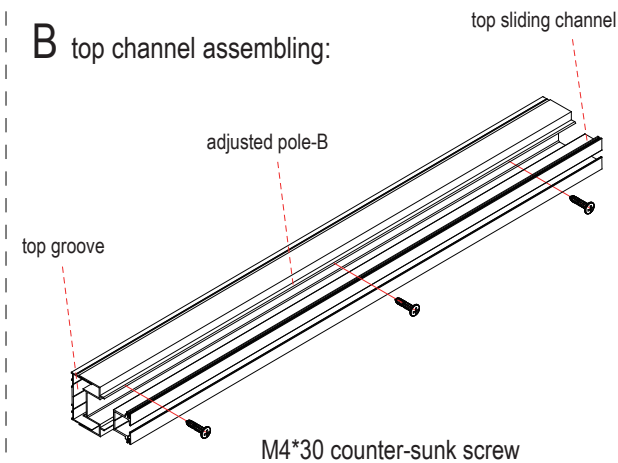

M4\*30 counter-sunk screw

M4\*30 counter-sunk screw with plastic insert

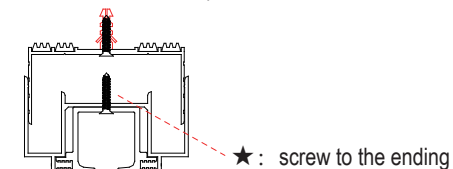

section

## C Door frame assembling:

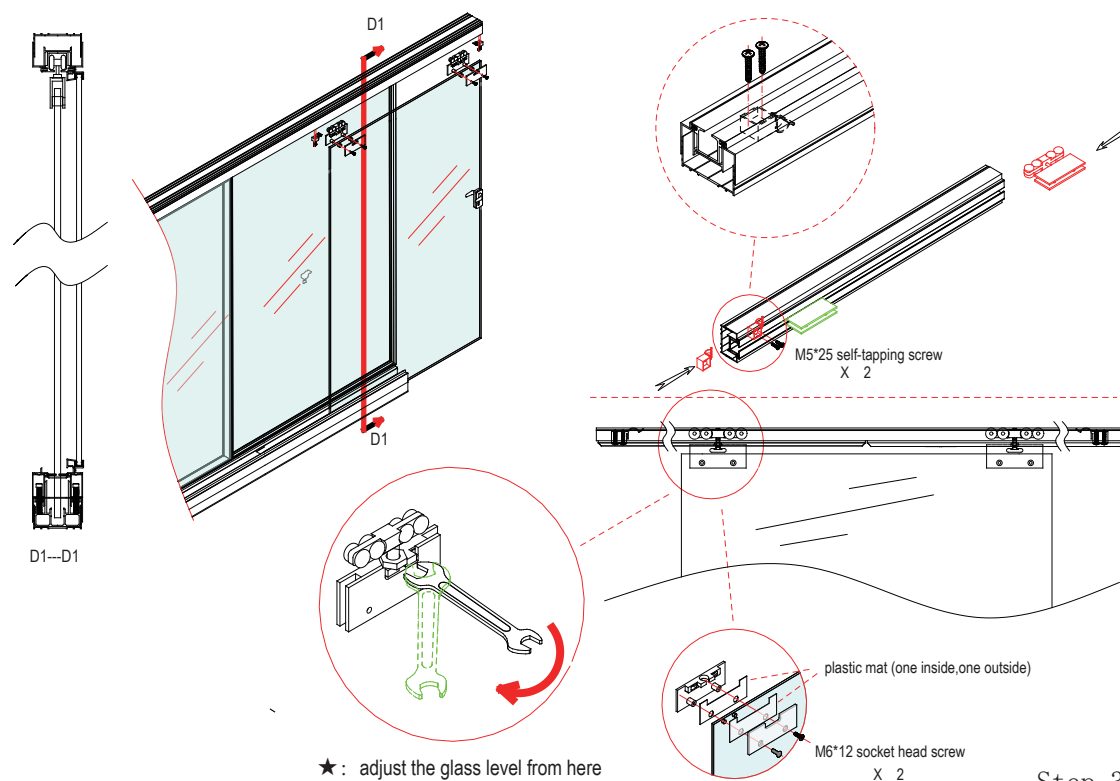
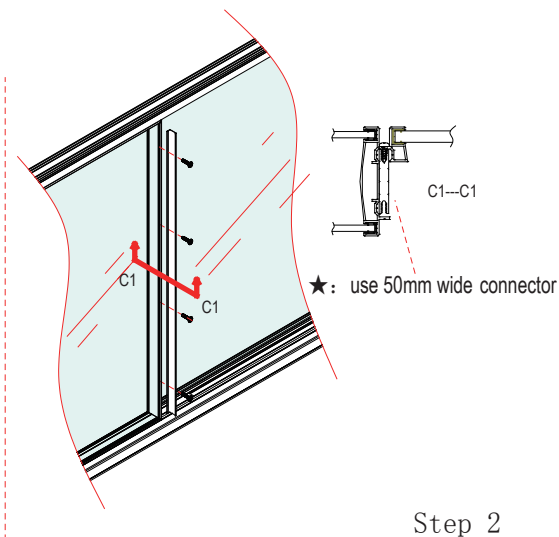
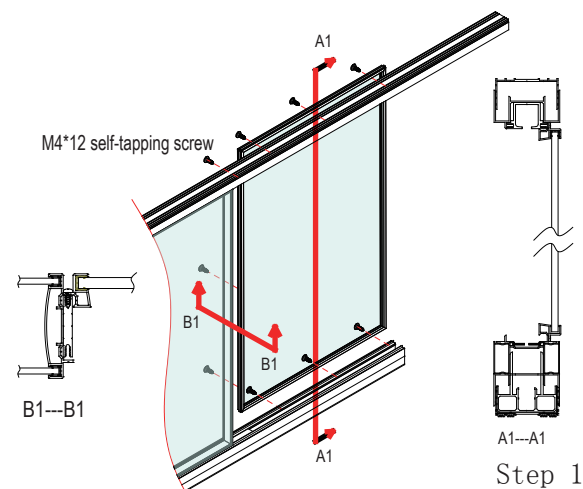
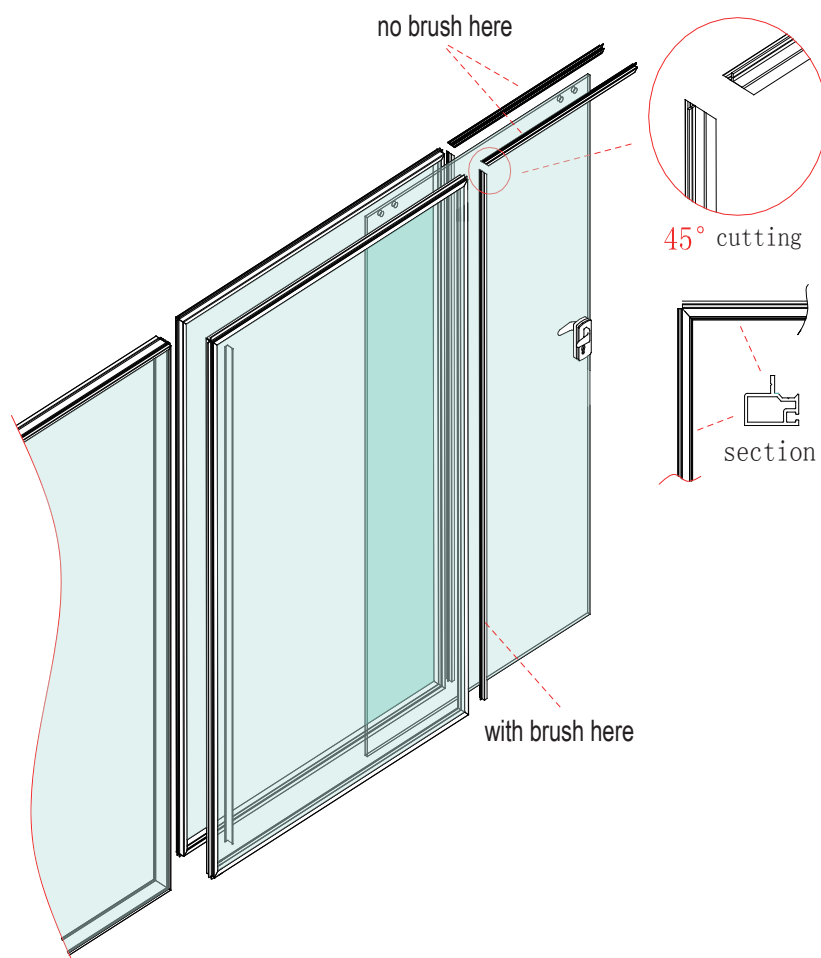

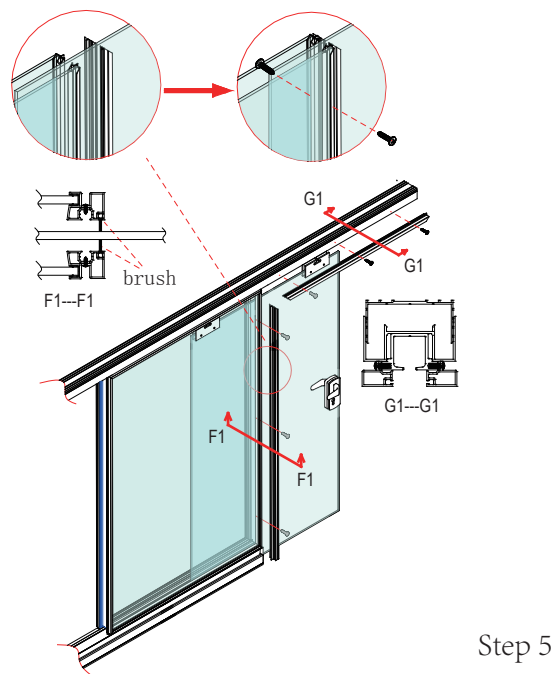
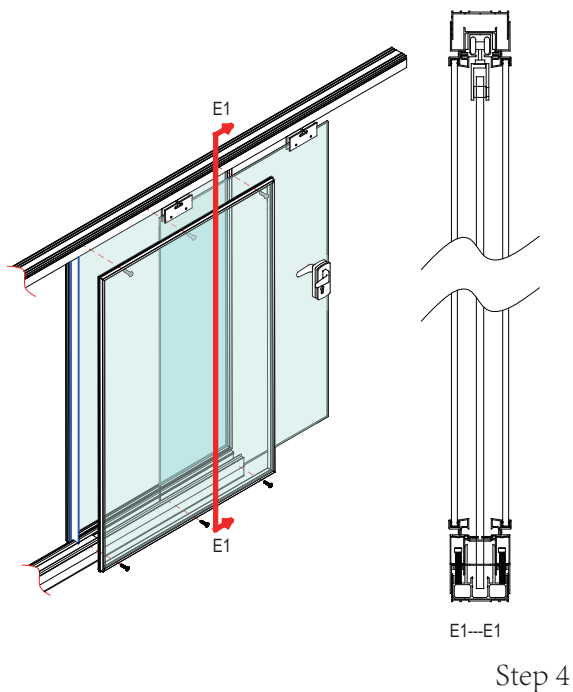

D: right door frame assembling:

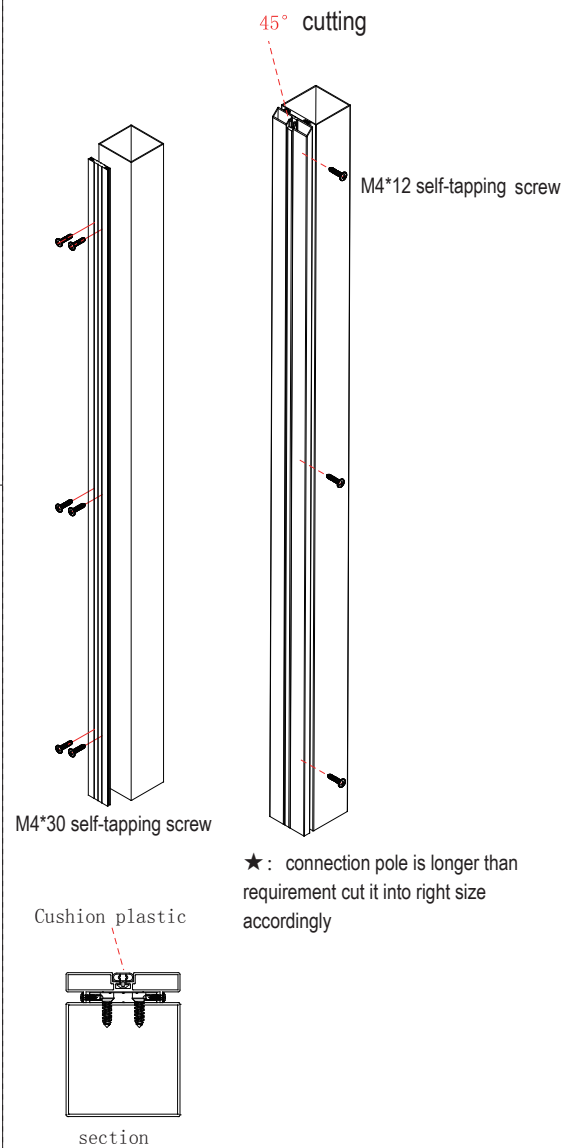

E: Lock assembling

Locking tab assembling :

